

TYPE WOE 5
Rigid Frame
Wheel Type Offset

woe6

PARTS LIST — Rigid Frame Wh

Ref. No.	Description	Model 1622,	WOE5 1624	Model 1822,	WOE5 1824	Model 2022,	WOE5 2024	Model 2222,	WOE5 2224
		Part No.	No. Req.	Part No.	No. Req.	Part No.	No. Req.	Part No.	No. Req.
1	Pull Tongue	1070	1	1070	1	1070	1	1070	1
2	Adj. Plate	5375	2	5375	2	5375	2	5375	2
	Machine Bolt — 3/4" x 4 1/2" USS	10048	4	10048	4	10048	4	10048	4
	Lock Washer — 3/4"	10002	4	10002	4	10002	4	10002	4
	Nut Hex — 3/4" USS	10143	4	10143	4	10143	4	10143	4
3	Cross Tongue	1082	1	1082	1	1082	1	1082	1
	Cap Screw — Hex. Hd. — 3/4" x 3" USS (Plated)	11024	2	11024	2	11024	2	11024	2
	Lock Washer — 3/4" (Plated)	10061	2	10061	2	10061	2	10061	2
	Nut — Hex 3/4" USS (Plated)	10072	2	10072	2	10072	2	10072	2
4	Hose Holder	102	1	102	1	102	1	102	1
	Cotter Pin — 1/4" x 1 1/2"	10075	1	10075	1	10075	1	10075	1
5	Stabilizer Rod	3008	1	3008	1	3008	1	3008	1
	Cotter Pin — 1/4" x 1 1/2"	10075	1	10075	1	10075	1	10075	1
	Machine Bolt — Hex Hd. — 5/8" x 3 3/4" USS	10241	1	10241	1	10241	1	10241	1
	Lock Washer — 5/8"	10010	1	10010	1	10010	1	10010	1
	Nut — Hex — 5/8" USS	11029	1	11029	1	11029	1	11029	1
6	Stabilizer Spring—2"—I. D. x 3"—O. D.—6" Long	10308	1	10308	1	10308	1	10308	1
7	Spring Guide Sleeve	773	1	773	1	773	1	773	1
8	Trunnion Stabilizer	774	1	774	1	774	1	774	1
	Machine Bolt — Hex Hd. — 5/8" x 1 1/2" (Plated)	10188	2	10188	2	10188	2	10188	2
	Lock Washer — 5/8" (Plated)	11002	2	11002	2	11002	2	11002	2
	Nut — Hex — 5/8" USS (Plated)	10139	2	10139	2	10139	2	10139	2
	Stop Stabilizer	775	1	775	1	775	1	775	1
9	Nut Adj. Stabilizer	776	1	776	1	776	1	776	1
10	Main Frame	1084	1	1084	1	1081	1	1081	1
11	Front Gang Frame	1089	1	1091	1	1079	1	1104	1
	Scraper Standard — RH	945	6	945	7	945	8	945	9
	Scraper End Special — RH	946	1	946	1	946	1	946	1
12	Rear Gang Frame	1090	1	1092	1	1080	1	1106	1
	Scraper Standard — LH	947	6	947	7	947	8	947	9
	Scraper End Special — LH	948	1	948	1	948	1	948	1
	Carriage Bolt — 7/16" x 1 1/2" USS	10068	28	10068	32	10068	36	10068	40
	Lock Washer — 7/16"	10619	28	10619	32	10619	36	10619	40
	Nut Hex — 7/16"	10618	28	10618	32	19618	36	10618	40
13	Carriage Bolt — 3/4" x 2" USS	10346	6	10346	6	10346	6	10346	6
	Lock Washer — 3/4"	10002	10	10002	10	10002	10	10002	10
	Nut — Hex 3/4" USS	10143	10	10143	10	10143	10	10143	10
14	"J" Bolt — 3/4" Dia.	4739	4	4739	4	4739	4	4739	4
15	Rockshaft	929	1	929	1	1106	1	1106	1
16	Base Rockshaft Brg.	3005	4	3005	4	5753	2	5753	2
17	Cap Rockshaft Brg.	3004	4	3004	4	5754	2	5754	2
	Machine Bolt — 5/8" x 5 1/2" USS	10064	8	10064	8				
	Lock Washer — 5/8"	10010	8	10010	8				
	Nut — Hex — 5/8" USS	11029	8	11029	8				
	Wheel Support					950	2	950	2
	Machine Bolt — 1" x 3" USS					11025	4	11025	4
	Lock Washer — 1"					11027	4	11027	4
	Nut — Hex — 1" USS					11026	4	11026	4
18	Transport Bar	1071	1	1071	1	1071	1	1071	1
	Rivet (Drilled) 5/8" x 2 1/2"	10031	1	10031	1	10031	1	10031	1

Machine Bolt — 7/8" x 7"
Lock Washer — 7/8"
Nut — Hex — 7/8"
4-Req. Each

(Continued on Next Page)

WHEN ORDERING PARTS,
PLEASE SPECIFY
TYPE, MODEL, SERIAL NO.

Ref. No.	Description	Model 1622,	WOE5 1624	Model 1822,	WOE5 1824	Model 2022,	WOE5 2024	Model 2222,	WOE5 2224
		Part No.	No. Req.	Part No.	No. Req.	Part No.	No. Req.	Part No.	No. Req.
	Cotter Pin — 1/4" x 1 1/2"	10075	2	10075	2	10075	2	10075	2
19	Bearing Housing — Front Half	3428	4	3428	6	3428	8	3428	8
20	Bearing Housing — Rear Half	3429	4	3429	6	3429	8	3429	8
	Carriage Bolt — 5/8" x 2 1/2" SAE	10183	8	10183	12	10183	16	10183	16
	Lock Washer — 5/8"	10010	8	10010	12	10010	16	10010	16
	Nut — Hex — 5/8" SAE	10187	8	10187	12	10187	16	10187	16
21	Hub W/2 Cups & 5 Lug Bolts	10351	2	10351	2	10351	2	10351	2
22	Cup Inner (Timken — LM 48510)	10352	2	10352	2	10352	2	10352	2
23	Cone Inner (Timken — LM 48548)	10353	2	10352	2	10353	2	10353	2
24	Grease Seal — AFS 2130	11017	2	11017	2	11017	2	11017	2
25	Hub Bolt	10354	10	10354	10	10354	10	10354	10
26	Nut — Hub (FS 8320)	11046	10	11046	10	11046	10	11046	10
27	Cup — Outer (LM 67010)	10293	2	10293	2	10293	2	10293	2
28	Cone — Outer (LM 67048)	10295	2	10295	2	10295	2	10295	2
29	Spindle Washer	10355	2	10355	2	10355	2	10355	2
30	Spindle Nut — 3/4" SAE (Slotted)	10290	2	10290	2	10290	2	10290	2
31	Cotter Pin — 3/16" x 1 1/2"	10027	2	10027	2	10027	2	10027	2
32	Hub Cap	10356	2	10356	2	10356	2	10356	2
33	Grease Fitting — Straight	10606	2	10606	2	10606	2	10606	2
34	Gang Bolt	3187	2	3188	2	3184	4	3184	2
	Gang Bolt							3185	2
35	Bumper Washer	2980	2	2980	2	2980	4	2980	4
36	Blade — 22" Cut Out	3044	16	3044	18	3044	20	3044	22
	Blade — 24" Cut Out	2369	16	2369	18	2369	20	2369	22
	Blade — 16" Plain	2445	1	2445	1	2445	1	2445	1
37	End Bell — Small	3421	4	3421	6	3421	8	3421	8
38	Housing Bearing	G2385	4	G2385	6	G2385	8	G2385	8
39	Bearing — Anti-Friction (GW210PP3)	G10271	4	G10271	6	G10271	8	G10271	8
40	Ring Retainer	11005	4	11005	6	11005	8	11005	8
41	End Bell Large	3422	4	3422	6	3422	8	3422	8
42	Spacer Spool	2672	10	2672	10	2672	8	2672	10
43	End Gang Washer	5092	2	5092	2	5092	4	5092	4
44	Cut Washer — 1 3/8"	10229	4	10229	4	10229	8	10229	8
45	Nut — Gang Bolt	10179	4	10179	4	10179	8	10179	8
	Grease Fitting 1/8" Straight	10606	4	10606	6	10606	8	10606	8
46	Cotter Pin — 1/4" x 2"	10087	4	10087	4	10087	8	10087	8
— OPTIONAL PARTS —									
	Wheel — 15 x 5 — KDC — 5-Hole	10025	2	10025	2	10025	2	10025	2
	Tire — 6:70 x 15 — 4-Ply — Imp.	11041	2	11041	2	11041	2	11041	2
	Tube — 6:70 x 15	11040	2	11040	2	11040	2	11040	2
	Wheel — Rim — Inner — 4:00 x 9	11009	2	11009	2	11009	2	11009	2
	Wheel — Rim — Outer — 4:00 x 9	11010	2	11010	2	11010	2	11010	2
	Tire — 6:00 x 9 — Pneumatic	11011	2	11011	2	11011	2	11012	2
	Tire — 6:00 x 9 — Laminated	10302	2	10302	2	10302	2	10302	2
	Tube — 6:00 x 9	11012	2	11012	2	11012	2	11012	2

ALEXANDER MANUFACTURING COMPANY

NO. 1 AMCO DRIVE

PHONE 746-4464

YAZOO CITY, MISS.—U.S.A.

PARTS LIST



Rigid Frame Wheel

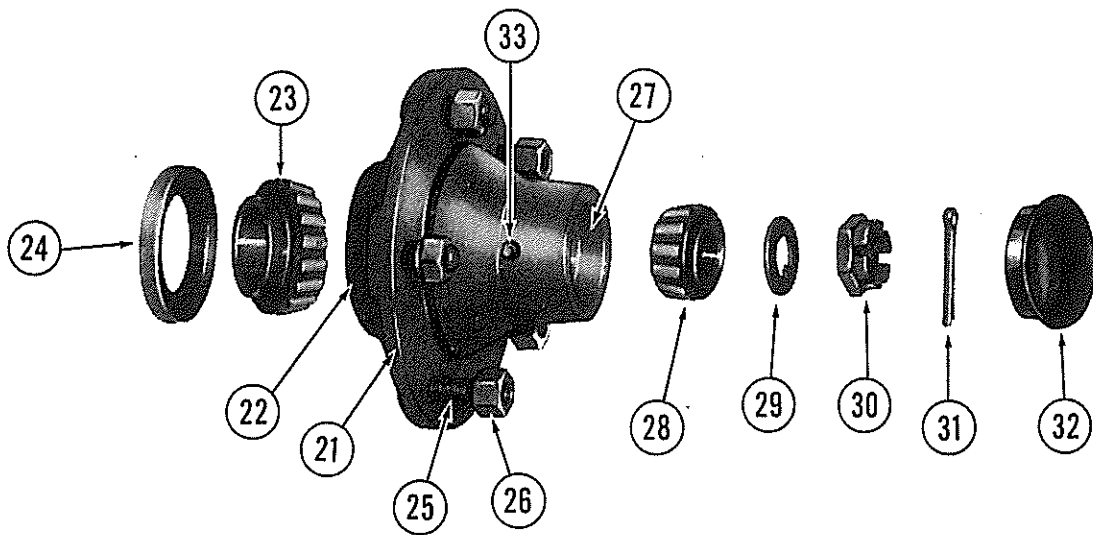
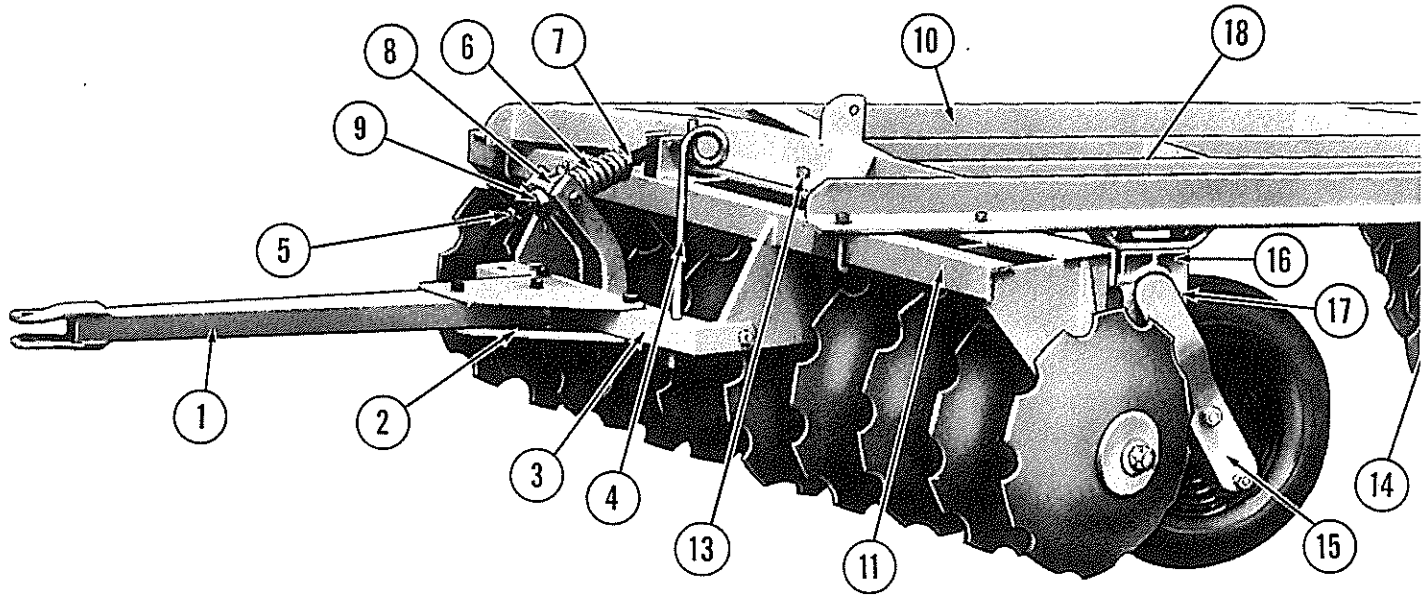

I Type Offset - WOE5

WHEN ORDERING PARTS,
PLEASE SPECIFY
TYPE, MODEL, SERIAL NO.

