

# PARTS LIST

# Amco

# MODEL WTD10

*W208PPB5*  
*WTD-*

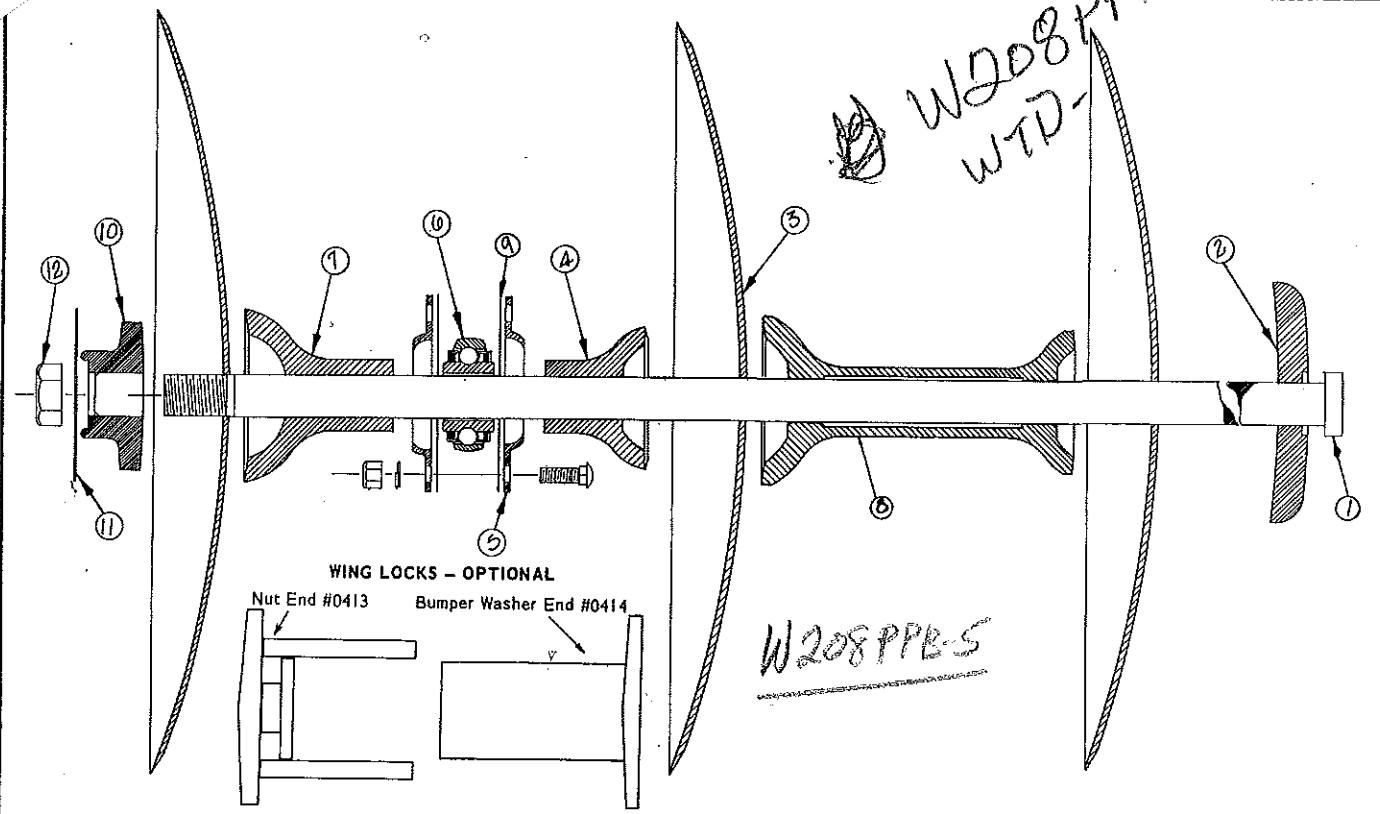

*W208PPB-5*

Ref. No.	Description	MODEL WTD10 48 Blade		MODEL WTD10 52 Blade	
		Part No.	Qty. Req.	Part No.	Qty. Req.
1	Gang Bolt (8 Blade)	5085	4	5085	4
1	Gang Bolt (4 Blade)	<del>2033</del>	4		
1	Gang Bolt (5 Blade)			2118	4
2	Bumper Washer	3412	8	3412	8
3	Blade 20" Cut Out	2122	48	2122	52
4	End Bell - Small	<i>6166A</i> 2917 ✓	20	2917	20
5	Flangette (NON-RE-LUBE)	10273	40	10273	40
5	Flangette (RE-LUBE) Grease Fitting	10444 ✓	20	10444	20
5	Flangette (RE-LUBE) Grooved	10445 ✓	20	10445	20
6	Bearing (NON-RE-LUBE)	<del>10272</del>	20	10272	20
6	Bearing (RE-LUBE)	<del>G10272</del>	20	G10272	20
7	End Bell - Large	<i>6167A</i> 2918 ✓	20	2918	20
8	Spacer Spool	<i>6165</i> 3408	20	3408	24
9	SHIM	8687	40	8687	40
10	End Gang Washer	2030	8	2030	8
11	Lock Plate	2116	8	2116	8
12	Nut-Gang Bolt 1-1/8"	11035	8	11035	8
	Carriage Bolt 7/16 x 1/4 NC	10274	60	10274	60
	Carriage Bolt 7/16 x 1 NC	10599	8	10599	8
	Lock Washer 7/16	10619	68	10619	68
	Hex Nut 7/16 NC	10618	68	10618	68
	(FOR MODELS WITH 7" SPACING)				
	End Bell - Small #7167				
	Spacer Spool #2854				

AMCO Division of DYNAMICS CORPORATION of AMERICA - P. O. Box 107, Yazoo City, Mississippi 39194

PARTS LIST



MODEL WTD10

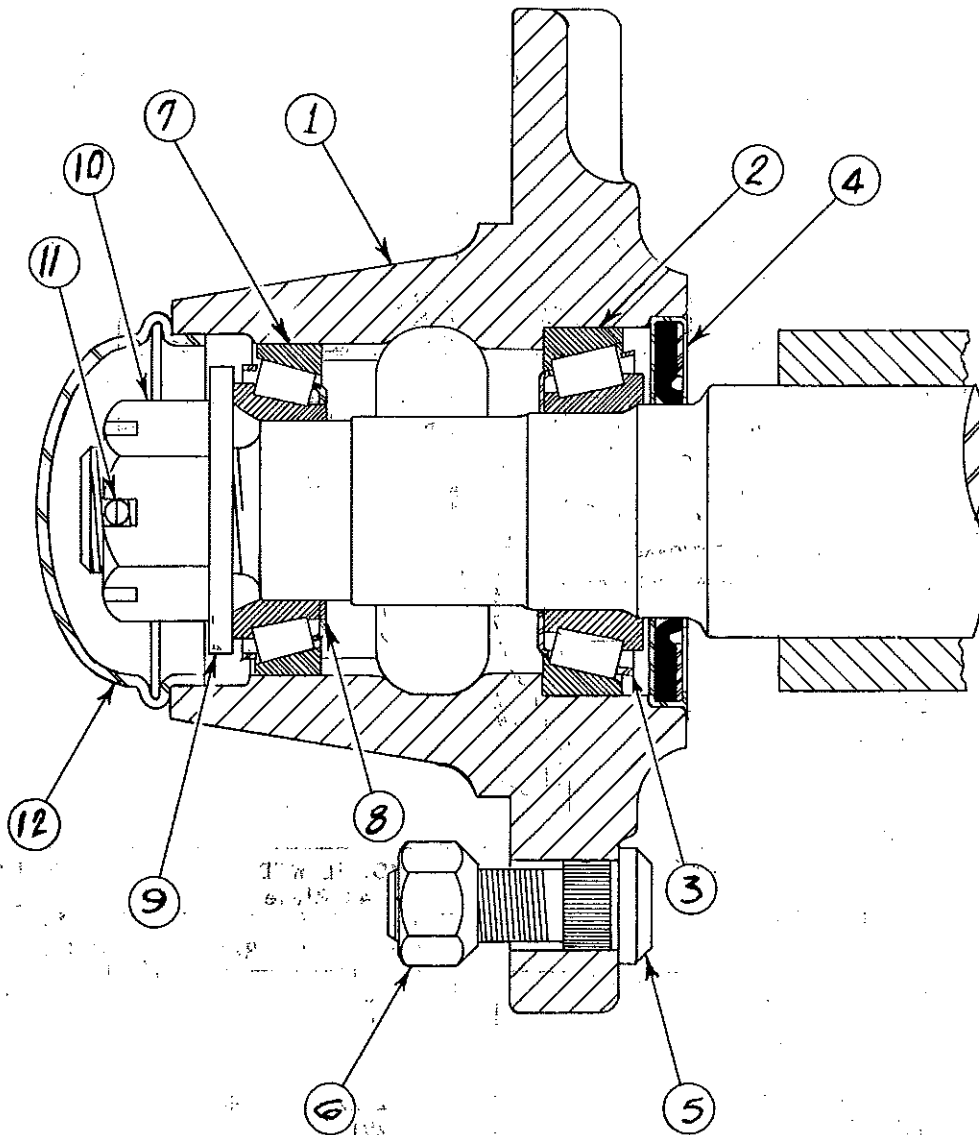

Ref. No.	Description	Part Number	Qty. Req.
1	Hub w/2 Cups and 5 Lug Bolts	10351	4
2	Cup Inner (Timken - LM 48510)	10352	4
3	Cone Inner (Timken - LM 48548)	10353	4
4	Grease Seal - AFS 2130	11017	4
5	Hub Bolt	10354	20
6	Nut - Hub (FS 8320)	11046	20
7	Cup - Outer (LM 67010)	10293	4
8	Cone - Outer (LM 67048)	10295	4
9	Spindle Washer	10355	4
10	Spindle Nut - 3/4" SAE (Slotted)	10290	4
11	Cotter Pin - 3/16" x 1-1/2"	10027	4
12	Hub Cap	10356	4