

OPERATING AND ASSEMBLY INSTRUCTIONS

AMCO Dozer Blade

MODEL NO. 805 Straight, Tilt and Angle



EFFECTIVE DATE

NOVEMBER 1, 1967

Alexander Manufacturing Company

*Manufacturers of Quality-Built Farm and
Industrial Equipment*

YAZOO CITY, MISSISSIPPI, USA

P. O. Box 107

Phone 746-4464

TO THE CUSTOMER:

Alexander Manufacturing Company would like to thank you for buying our Model 805 Farm Tractor Dozer. This dozer was designed and manufactured for the farmer who demands superior performance and dependability in a piece of farm equipment.

The AMCO Model 805 Farm Tractor Dozer was designed to mount on farm tractors with 70 to 110 horsepower. This dozer will put you in control of a machine that weighs 10,000 to 15,000 pounds and is capable of pushing 8,000 to 14,000 pounds. The AMCO Model 805 Farm Tractor Dozer comes equipped with a heavy duty, front mounted hydraulic cylinder. This puts you in control of over 10,000 pounds of lifting force at the tip of the mold-board. This is power to spare for the most rugged jobs. Yet, you still have precise control of your dozer for those jobs that require the utmost precision.

The Model 805 Farm Tractor Dozer gives you performance and ease of adjustability that is superior to any other farm tractor dozer on the market. **But remember, this is a farm tractor dozer mounted on a farm tractor. Care should be taken to see that this machine is not abused. Abuse can damage your dozer and tractor.**

This operator's manual was prepared for your convenience. The mounting instructions will save you considerable time and effort in mounting the dozer on your tractor. Instructions on adjusting and operating the dozer will help you obtain the maximum benefit from the many features designed into your AMCO Model 805 Farm Tractor Dozer. Please read this operator's manual for your benefit.

Sincerely yours,

ALEXANDER MANUFACTURING COMPANY

TABLE OF CONTENTS

	Page	
Model 805 Dozer Blade -		
Straight, Tilt and Angle	5	Fig. 1
Parts List,	6	
Attaching Instructions	7	
Instructions for Operation and Adjustment of the Model 805 Farm Tractor Dozer,	8	
Maintenance Instructions	8	
ACCESSORIES		
Brush Guard	9	
Brush Rack	9	
ATTACHING KITS		
Parts List and Attaching Instructions for the IH 14 Kit (Farmall 706, 806),	11	Fig. 2
Parts List and Attaching Instructions for the IH 15 Kit (Farmall 806, 1206),	12	Fig. 3
Parts List and Attaching Instructions for the JD 21 Kit (John Deere 3010, 3020, 4010, 4020),	13	Fig. 4
Parts List and Attaching Instructions for the AC 31 Kit (Allis Chalmers 190, 190 XT),	14	Fig. 5
Parts List and Attaching Instructions for the JC 52 Kit (J. I. Case 930, 1030 Row Crop),	15	Fig. 6
Parts List and Attaching Instructions for the MF 72 Kit (Massey Ferguson 1100, 1130),	16	Fig. 7
Parts List and Attaching Instructions for the MM 81 Kit (Minneapolis Moline 670 Super),	17	Fig. 8
Parts List and Attaching Instructions for the OC 91 Kit (Oliver 1800, 1850),	18	Fig. 9

AMCO DOZER MODEL 805

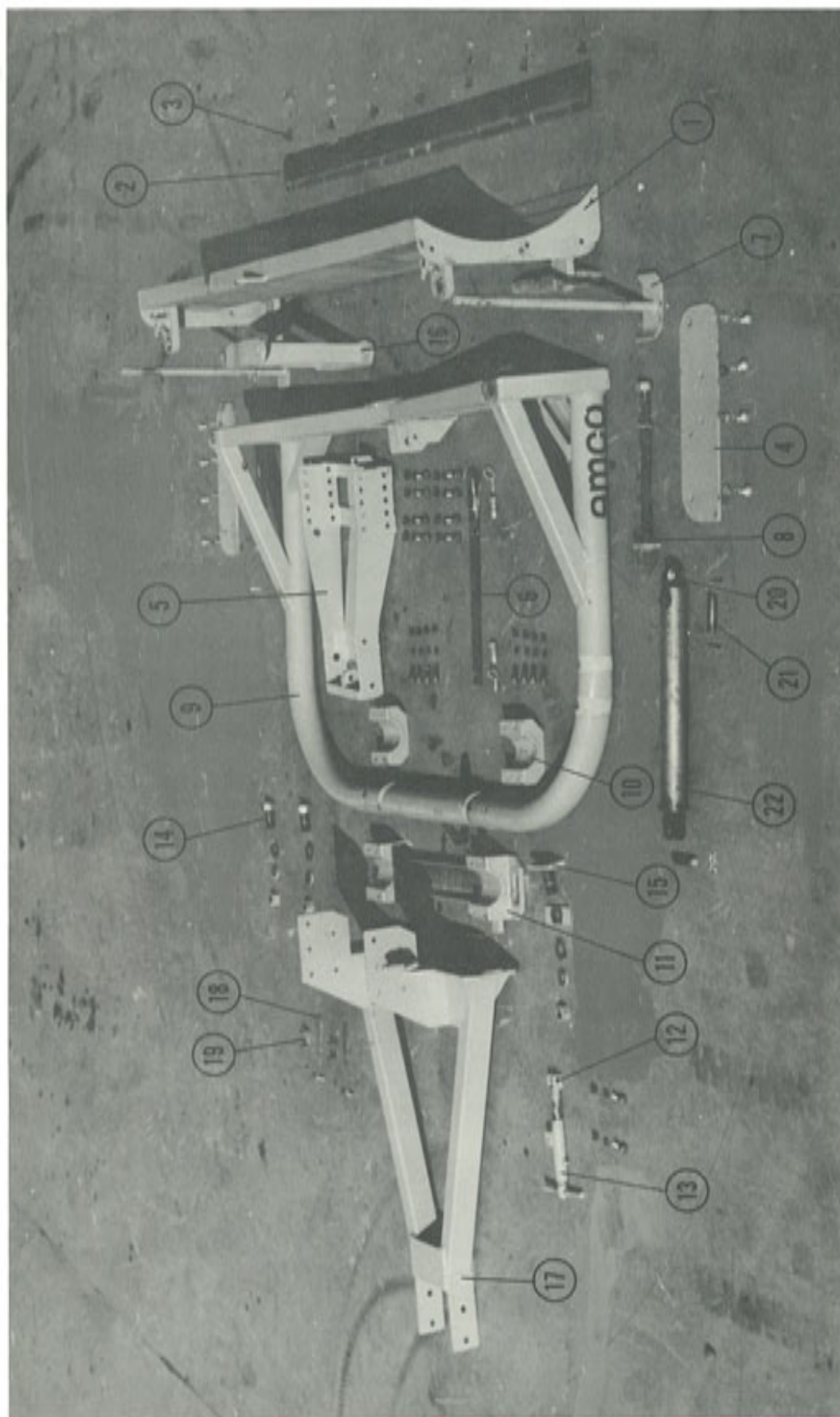

MODEL 805 DOZER BLADE
for Farm Tractors

(FIG. 1)

SEE DESCRIPTION - REVERSE SIDE

MODEL 805 DOZER BLADE

PARTS LIST

Ref. No.	Description	Part Number	No. Req.
1	Blade, Mold Board.....	1578	1
2	Edge (Cutting).....	6719	1
	Set Screw 5/8 x 1 1/2 NC.....	10137	4
3	Plow Bolt 5/8 x 1 1/4 NC.....	10662	7
	Lock Washer 5/8 (Plated).....	11002	7
	Hex Nut 5/8 NC HT (Plated).....	10668	7
4	End Plate.....	6720	2
	Carriage Bolt 5/8 x 1 1/2 NC (Plated).....	10680	8
	Lock Washer 5/8 (Plated).....	11002	8
	Hex Nut 5/8 NC HT (Plated).....	10668	8
5	Radiator Guard & Cylinder Mount Bracket.....	1781	1
6	Transport Bar.....	1835	1
	Rivet 3/4 x 2 1/2 .. s.....	10019	2
	Klik Pin 3/4.....	10317	2
	Machine Bolt 3/4 x 2 1/2 NC (Plated) HT.....	10678	8
	Lock Washer 3/4 (Plated).....	10061	8
	Hex Nut 3/4 NC (Plated).....	10669	8
7	Depth Gauge.....	1579	2
8	Bolt-Anchor..... s.....	1580	2
	Lock Washer 1 1/4.....	10192	2
	Hex Nut 1 1/4 NC.....	10149	2
9	Main Frame.....	1782	1
10	Bearing Cap.....	1581	2
	Machine Bolt 3/4 x 2 NC HT (Plated).....	10670	8
	Lock Washer 3/4 (Plated).....	10061	8
	Hex Nut 3/4 NC HT (Plated).....	10669	8
11	Bearing Journal.....	1783	1
12	Adjusting Leg.....	1583	1
13	Guide Sleeve.....	1584	1
	Grease Fitting.....	10721	1
	Machine Bolt 5/8 x 2 NC (Plated).....	10239	2
	Lock Washer 5/8 (Plated).....	11002	2
	Hex Nut 5/8 NC HT (Plated).....	10668	2
14	Pivot Bolt.....	1586	2
15	Anchor Bolt.....	1587	1
	Washer (Fab.).....	6751	1
	Cut Washer 1-3/8.....	10229	2
	Lock Washer 1-3/8.....	10673	3
	Hex Nut 1-3/8 NF THD.....	10088	3
16	Angle Bracket.....	1589	1
17	Frame Carriage.....	1784	1
18	Hose Holder.....	7368	2
19	Hose Clamp.....	7369	2
	Carriage Bolt 3/8 x 2 1/2 NC.....	10724	2
	Lock Washer 3/8.....	11070	2
	Hex Nut 3/8 NC.....	11074	2
20	Cylinder (Hydraulic).....	10729	1
21	Ball Adapter.....	1785	1
22	Connecting Pin 1" Dia.....	7397	1
	Cotter Pin 3/4 x 2.....	10087	2

OPTIONAL EQUIPMENT

Brush Guard (Model 80).....	1786	1
Tie Bar (Model 80).....	7399	2
Brush Rack (Model 100).....	1860	1

INSTRUCTIONS FOR ATTACHING THE AMCO MODEL 805 FARM TRACTOR DOZER TO THE TRACTOR

- I. The mounting kit should already be attached to the tractor as described in mounting kit attaching instructions. The entire dozer should be on the ground with the dozer cutting edge down.

II. Instructions for Attaching the Assembled Dozer to the Tractor:

Drive the tractor's front wheels over the "C" frame (Fig. 1 No. 9). The tractor's front wheels should be inside the "C" frame and the holes in the front mount plates should be over the mounting holes in the dozer carriage frame (Fig. 1 No. 17). Lift the front of the carriage frame and insert one 5/8" diameter carriage bolt through the front mount plate and the carriage frame mounting plate. Repeat this procedure by placing a bolt through the front mount plate and carriage frame mounting plate on the opposite side of the tractor. Tighten the two bolts hand tight.

Lift the rear of the carriage frame and attach it to the rear mount bracket that was previously mounted on the tractor. Use the 7/8" diameter bolts supplied with the mounting kit for this operation. Tighten the bolts hand tight.

Insert four 5/8" diameter carriage bolts through the left front mount plate and the carriage frame mounting plate and tighten these bolts hand tight. Repeat this procedure on the right side.

The adjusting leg and guide sleeve (Fig. 1 No. 12, 13) should now be mounted on the right front of the carriage frame (Fig. 1 No. 17).

The radiator guard assembly (Fig. 1 No. 5) should be mounted on the front of the tractor. The open side of the guard should be toward the front. Use the center set of holes for mounting the radiator guard. The radiator guard has 3 set of holes. These additional holes can be used to adjust the lift span of the blade.

III. Instructions for Attaching the Partially Assembled Dozer to the Tractor:

After the dozer has been mounted on the tractor, the dozer can be disassembled at the bearing caps (Fig. 1 No. 10). The carriage frame can be left on the tractor and the tractor can be used for other jobs.

The hydraulic cylinder should be disconnected. Then remove the four bolts that hold each bearing cap and journal in place, lower the "C" frame to the ground and back the tractor away from the "C" frame.

To remount the "C" frame, drive the tractor over the "C" frame. Then connect the hydraulic cylinder, replace the bearing caps and journals. Then tighten all bolts securely.

IV. Instructions for Attaching the Hydraulic Cylinder:

The AMCO farm tractor dozer is designed to be raised and lowered by a special heavy duty hydraulic cylinder which is furnished with the dozer as standard equipment.

NOTE: The two hydraulic hoses are not furnished as standard equipment.

The two hydraulic hoses should have an inside diameter of 3/8" or 1/2" and be able to operate at pressures over 2,000 lbs. per square inch. Most tractors will require two hoses 12 to 16 feet long.

The rear of the cylinder should be attached to the upper part of the radiator guard. The rod end of the cylinder should be attached to the bracket on the "C" frame (Fig. 1, No. 9).

The two hoses should be attached to the cylinder and clamped to the left side of the tractor. Two clamps are provided to clamp the hoses. These clamps can be mounted at any convenient location on the left side of the tractor. The two hoses should now be connected to the tractor's hydraulic fluid outlets.

Pushing the hydraulic control lever forward should lower the dozer blade. If this raises the blade, swap the hoses on the tractor's hydraulic fluid outlets. Pushing the control lever forward should lower the dozer blade and pulling the lever to the rear should raise it.

CAUTION!

Be sure and tighten all bolts before operating the dozer.

INSTRUCTIONS FOR OPERATION AND ADJUSTMENT OF THE AMCO MODEL 805 FARM TRACTOR DOZER

I. Cutting Depth:

The cutting depth of the dozer is regulated by the hydraulic cylinder. In addition to the hydraulic cylinder, the AMCO Model No. 805 Farm Tractor Dozer has a set of two depth gauges (Fig. 1 No. 7) as standard equipment. These depth gauges can be used to keep the dozer from going too deep at the beginning of a cut. Also, the depth gauges can be used when scraping a feed lot or on many other dozing jobs.

The height of the depth gauge is regulated by loosening the set screws at the upper outside corners of the moldboard (Fig. 1 No. 1) sliding the depth gauge to the desired setting and tightening the set screws.

II. Lift Span Adjustment:

The radiator guard (Fig. 1 No. 5) has 3 sets of mounting holes. The lift span of the blade can be varied by using the various sets of mounting holes.

III. Tilting the AMCO Model No. 805 Farm Tractor Dozer:

The AMCO Model No. 805 Farm Tractor Dozer Blade can be tilted about seven inches to the right or left. Before tilting the dozer, loosen the 1-3/8" diameter slide bolt on the right front corner of the carriage frame (Fig. 1 No. 15) then loosen the two pivot bolts on the left front corner of the carriage frame (Fig. 1 No. 14). Tilt the blade with the screw jack, located on the right side of the bearing journal (Fig. 1 No. 12 & 13).

CAUTION: Be sure and thoroughly tighten the slide bolt and two pivot bolts before operating the dozer.

IV. Angle Bracket: (Fig. 1 No. 16)

The bracket can be used to angle the dozer to the right or left. To mount the bracket, lift the dozer to the highest position. Remove the bolt that holds the moldboard to the "C" frame on the side you wish to mount the bracket (Fig. 1 No. 8). Loosen the set screws that hold the depth gauge in place (Fig. 1 No. 1). Swing the moldboard out from the "C" frame and remove the depth gauge (Fig. 1 No. 7). Place the angle bracket between the mounting lugs on the moldboard and replace the depth gauge sliding it up through the holes in the angle bracket. Mount the other end of the bracket to the "C" frame with the anchor bolt (Fig. 1 No. 8).

It is not necessary to completely remove the angle bracket to change the dozer back to the straight position. Remove the anchor bolt that holds the angle bracket to the "C" frame. Move the moldboard forward and fold the angle bracket toward the center of the dozer. Move the moldboard back to the "C" frame and replace the anchor bolt.

V. Dozer Blade End Plates: (Fig. 1 No. 4)

The two end plates can be removed from the dozer blade or left on the dozer blade. Leaving the plates on will help hold dirt when pushing. Removing the plates will aid in dirt flow when using the dozer in the tilt or angle position.

VI. Transport Bar: (Fig. 1 No. 6)

A transport bar is provided with the AMCO Model No. 805 Farm Tractor Dozer. This bar should be attached to the radiator guard when not in use. If you wish to remove the hydraulic cylinder or disconnect the hydraulic cylinder you can attach the lower part of the transport bar (Fig. 1 No. 6) to the bracket on the "C" frame (Fig. 1 No. 9). This bar will hold the dozer in the raised position.

INSTRUCTIONS FOR MAINTENANCE OF THE AMCO MODEL 805 FARM TRACTOR DOZER

Regardless of how well a piece of machinery is built, it needs occasional maintenance to keep it operating at peak efficiency. The AMCO Farm Tractor Dozer is no exception. A few minutes spent in maintenance will add to the life of the dozer. We recommend good operator practices in addition to the following periodic maintenance.

1. Grease the two bearing caps (Fig. 1 No. 10) with a good grade of pressure gun or chassis grease before using the dozer. The bearings should then be greased every day or after every 10 hours of operation.
2. Check all bolts and make sure they are tight before using the dozer. After the first 10 hours of operation, the bolts should be rechecked for tightness. After the first 10 hours of operation, the bolts

should be checked at least every 50 hours of operation.

3. The AMCO Model 805 Farm Tractor Dozer is equipped with a High Carbon Steel cutting edge. Should this edge become worn the blade can be reversed by removing the bolts and turning the cutting edge over.

Remember, the 805 dozer is a farm tractor dozer mounted on a farm tractor. The tractor and dozer were not designed for pushing trees or for heavy clearing land.

Abusing the dozer could cause serious damage to the dozer and tractor. AMCO will not be responsible for any damage to the tractor under any circumstances. Also, AMCO will not guarantee any part of any dozer that has been abused.

BRUSH GUARD

Brush Guard:

The brush guard was designed to mount on your AMCO farm tractor dozer's radiator guard (Fig. 1 No. 5). This guard is designed to protect your hydraulic cylinder, hydraulic hoses and tractor from light brush and trash.

The AMCO Brush Guard should not be used when in heavy brush. The Brush Guard should not be used with the Brush Rack.

PARTS LIST

Ref. No.	Part No.	Description	No. Req.
1	1786	Brush Guard	1
2	7399	Tie Bar	2
3	10074	Machine Bolt $\frac{3}{4}$ x 2 USS Plated	6
4	10061	Lock Washer $\frac{3}{4}$ Plated	6
5	10072	Hex Nut $\frac{3}{4}$ USS Plated	6

BRUSH GUARD ATTACHING INSTRUCTIONS

The two mounting lugs on the brush guard mount near the top of the radiator guard (Fig. 1 No. 5). Use two $\frac{3}{4}$ " x 2" machine bolts to attach the Brush Guard to the radiator guard.

Mount the hold straps to the bottom set of holes on the brush guard. Attach the hold straps to any convenient hole in the lower portion of the radiator guard (Fig. 1 No. 5).

CAUTION: Before tightening any bolts raise the dozer and be sure that the brush guard clears the hydraulic cylinder and dozer blade.

If the blade or hydraulic cylinder do not clear the guard, the guard can be adjusted by using an alternate set of holes in the hold strap. After checking for clearance tighten all bolts securely.

BRUSH RACK

The brush rack was designed to mount on your AMCO Farm Tractor Dozer's moldboard. This rack was designed to protect your tractor and operator from brush and trash. This rack will also aid in piling brush or trash.

CAUTION: The AMCO Brush Rack was designed to protect your tractor and operator.

Brush Rack Attaching Instructions:

The brush rack was designed to mount on your AMCO Farm Tractor Dozer's moldboard. Remove the end plates (Fig. 1 No. 4) from the dozer moldboard (Fig. 1 No. 1) and use the end plate bolts to mount the brush rack to the moldboard.

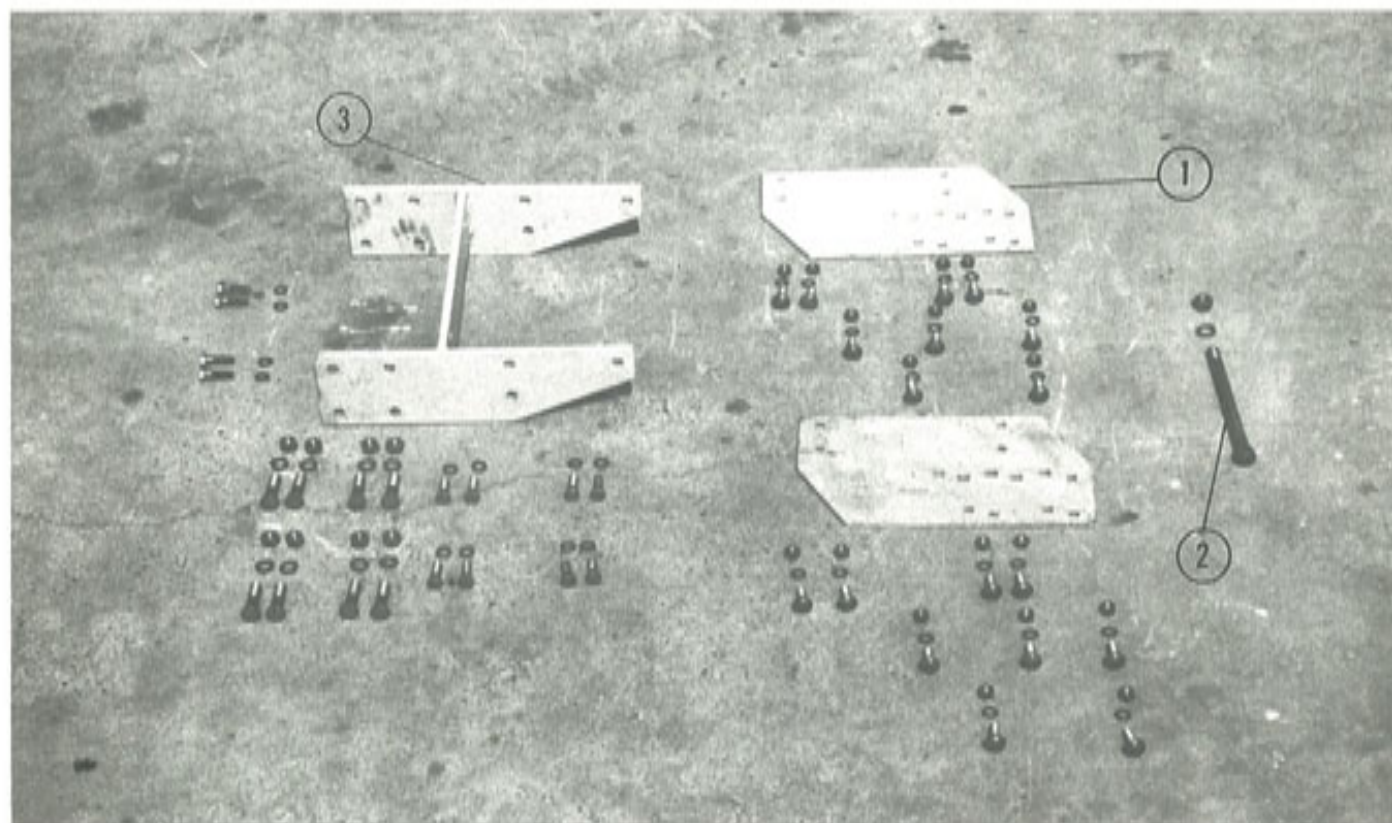

(FIG. 2)

MODEL IH-14 - ADAPTING KIT - FARMALL 706 AND 806

PARTS LIST

Ref. No.	Description	Part No.	No. Req.
1	Front Mount Plate	6789	2
	Carriage Bolt 5/8 x 2 NC (P & HT)	10665	18
	Cap Screw 5/8 x 2 1/2 NC (P & HT)	10674	12
	Lock Washer 5/8	11002	30
	Hex Nut 5/8 NC (P & HT)	10668	18
	Cap Screw 3/4 x 2 NC (P & HT)	10670	4
	Lock Washer 3/4 (Plated)	10061	4
2	Machine Bolt (Fab.)		1
	Lock Washer 7/8 (Plated)	10391	1
	Hex Nut 7/8 NC (Plated)	10436	1
3	Radiator Guard Mount	1792	1

INSTRUCTIONS FOR ATTACHING AMCO FARM TRACTOR DOZER MOUNTING KIT NO. IH-14 TO FARMALL 706 AND 806 TRACTORS

I. Attaching Front Mount Plates: (Fig. 2 No. 1)

The front mount plates mount on each side of the tractor near the rear of the engine. The two plates are designed to mount with the four round holes on top and toward the front of the tractor.

The plates must be mounted in the rear set of holes on the Farmall 806 Tractor's side frame and the front set of holes on the Farmall 706 Tractor's side frame. Leave all bolts loose until the entire dozer has been mounted on the tractor, then tighten all bolts securely.

The side plates are interchangeable on Farmall 706 and 806 tractors. When mounting the dozer, use the upper forward set of square holes for the Farmall 806 tractor and the lower rearward set for the Farmall 706 tractor. A rear mount bracket is not required for kit No. IH-14.

II. Attaching Radiator Guard Mount: (Fig. 2 No. 3)

Remove the weights and weight support bracket from the front of the tractor.

Remove the two front bolts from each side of the tractor's side frame.

Bolt the Radiator Guard Mount to the tractor using six 5/8" diameter bolts on each side of the tractor and two 3/4" diameter bolts on the front of the tractor.

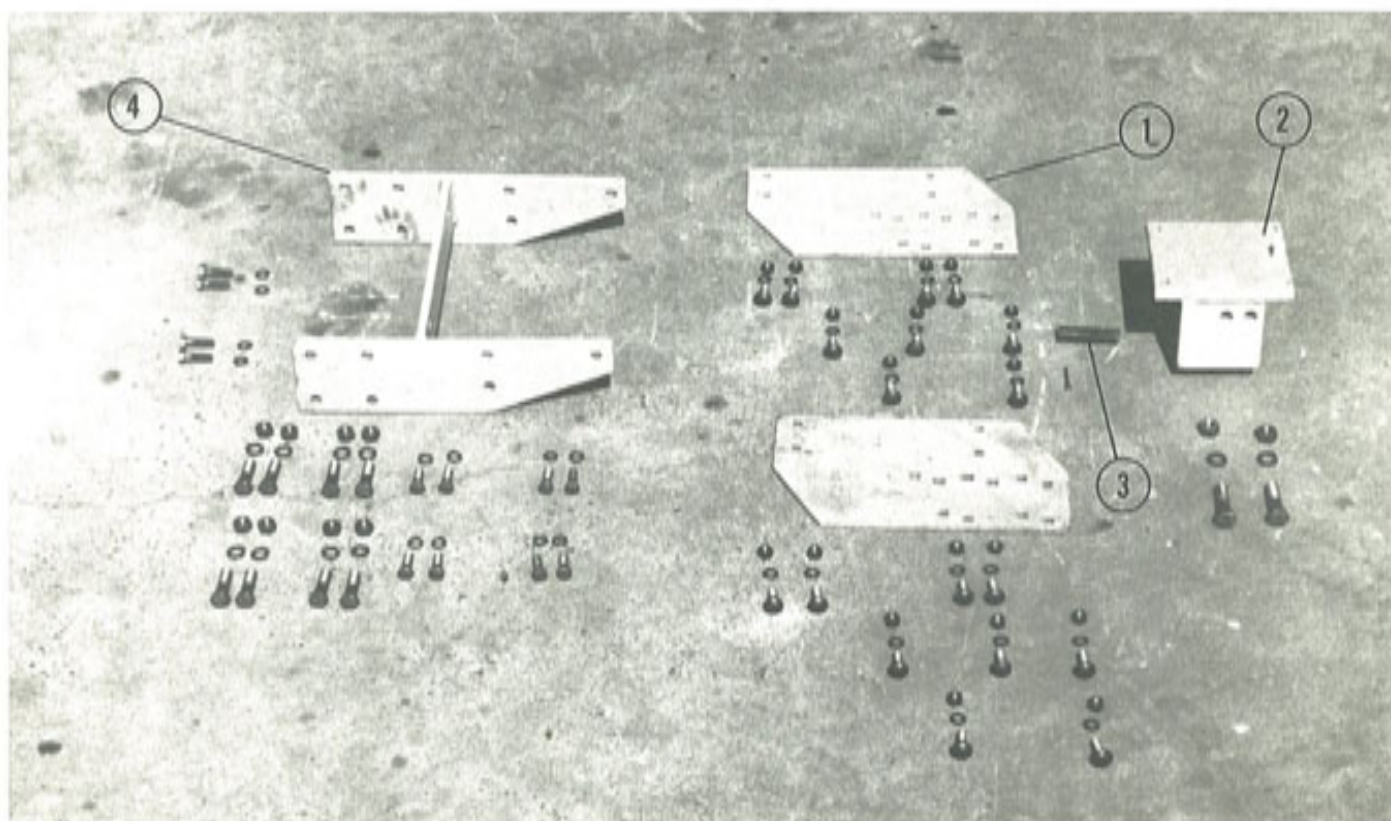

(FIG. 3)

MODEL IH-15 - ADAPTING KIT - FARMALL 1206

PARTS LIST

Ref. No.	Description	Part No.	No. Req.
1	Front Mount Plate	6789	2
	Carriage Bolt 5/8 x 2 NC (P & HT)	10665	18
	Cap Screw 5/8 x 2 1/2 NC (P & HT)	10674	12
	Lock Washer 5/8 (P)	11002	30
	Hex Nut 5/8 NC (P & HT)	10668	30
	Cap Screw 3/4 x 2 NC (P & HT)	10670	4
	Lock Washer 3/4 (P)	10061	4
2	Rear Mount Bracket	1662	1
	Machine Bolt 7/8 x 3 NC	10189	2
	Lock Washer 7/8	10035	2
	Hex Nut 7/8 NC	10148	2
3	Retainer Pin	6979	1
	Cotter Pin 1/4 x 1 1/2	10075	1
4	Radiator Guard Mount	1792	1

INSTRUCTIONS FOR ATTACHING AMCO FARM TRACTOR DOZER MOUNTING KIT NO. IH-15 TO FARMALL 1206 TRACTORS

- I. **Attaching Rear Mount Bracket:** (Fig. 3 No. 2)
Remove the pin that holds the tractor's swinging drawbar in place, then remove the drawbar support bracket.
Mount the rear mount bracket (Fig. 3 No. 2) in place of the drawbar support bracket. Re-attach the swinging drawbar using the 1-1/8" diameter pin and klik pin supplied with the dozer kit.

If desired, the dozer rear mount bracket (Fig. 3 No. 2) can be left on the tractor when the dozer is removed.

- II. **Attaching Front Mount Plates:** (Fig. 3 No. 1)
The two front mount plates mount on each side of the tractor near the rear of the engine. The two plates are designed to mount with the four round holes on top and toward the front of the tractor.
The plates must be mounted in the rear set of holes on the Farmall 1206 Tractor's side frame. Leave all bolts loose until the entire dozer has been mounted on the tractor, then tighten all bolts securely.

When mounting the dozer, use the upper forward set of square holes in the mounting plates.

NOTE: The IH-15 dozer mounting kit can be used on Farmall 806 Tractors as well as Farmall 1206 Tractors.

- III. **Radiator Guard Mount:** (Fig. 3 No. 4)
Remove the weights and weight support bracket from the front of the tractor.
Remove the two front bolts from each side of the tractor's side frame.
Bolt the Radiator Guard Mount to the tractor using six 5/8" diameter bolts on each side of the tractor and two 3/4" diameter bolts on the front of the tractor.

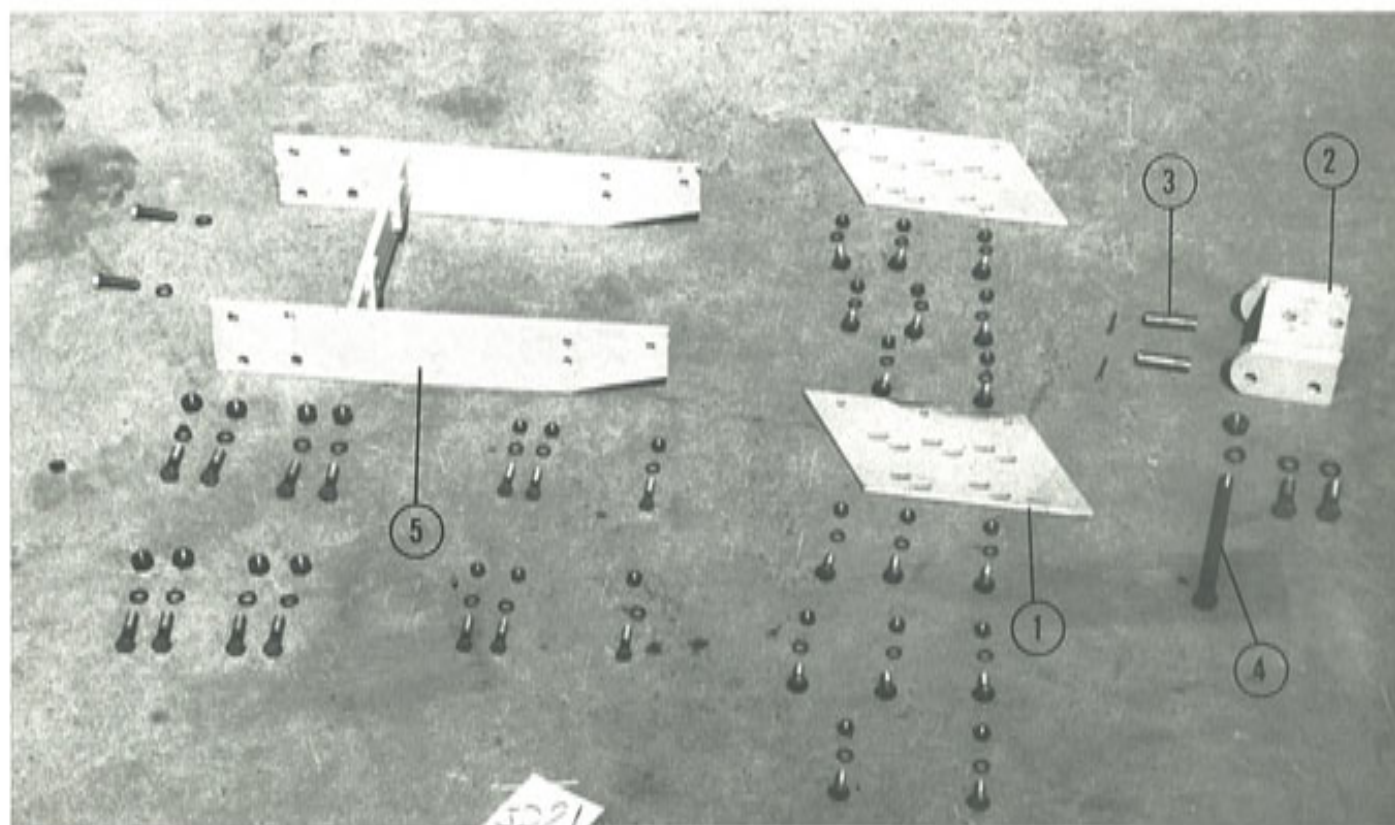

(FIG. 4)

MODEL JD-21 - ADAPTING KIT - JOHN DEERE 3010, 3020, 4010, 4020

PARTS LIST

Ref. No.	Description	Part No.	No. Req.
1	Front Mount Plate	6802	2
	Carriage Bolt 5/8 x 2 NC (P & HT)	10665	16
	Lock Washer 5/8 (P)	11002	16
	Hex Nut 5/8 NC (P & HT)	10668	16
2	Rear Mount Bracket	1603	1
3	Mounting Pin	6806	2
	Cotter Pin 1/4 x 2	10087	2
	Machine Bolt 7/8 x 3 1/2 NC	10475	2
	Lock Washer 7/8 (Plated)	10391	2
4	Machine Bolt (Fab.)	1594	1
	Lock Washer 7/8 (Plated)	10391	1
	Hex Nut 7/8 NC (Plated)	10436	1
5	Radiator Guard Mount	1793	1
	Cap Screw 5/8 x 2 1/2 NC (P & HT)	10674	6
	Lock Washer 5/8 (Plated)	11002	6
	Cap Screw 3/4 x 2 1/2 NC (P & HT)	10678	2
	Lock Washer 3/4 (Plated)	10061	2

INSTRUCTIONS FOR ATTACHING AMCO FARM TRACTOR DOZER MOUNTING KIT NO. JD-21 TO JOHN DEERE 3010, 3020, 4010, AND 4020 TRACTORS

I. Attaching Rear Mount Bracket: (Fig. 4 No. 2)

The rear mount bracket is designed to mount on the front end of the tractor's swinging drawbar. Remove the pull pin that holds the swinging drawbar

in place, and slide the drawbar as far forward as possible. After sliding the drawbar forward, replace the pull pin and fasten the drawbar at the rear of the tractor to keep it from swinging. Slide the rear mount bracket onto the front of the drawbar. The smooth side of the bracket should be on top and the straight side should be toward the rear of the tractor. Insert the two 1" diameter Dowel pins through the rear mount bracket and tractor drawbar. Secure the Dowel Pins with the two cotter pins furnished with the mounting kit.

II. Attaching Front Mount Plates: (Fig. 4 No. 1)

The two front mount plates mount on each side of the tractor near the motor. The two plates are designed to mount with the three round holes on top and the plate inclined forward. The plate should be mounted using the three center square holes on the 4010, and 4020 side frame and the second, fourth and fifth square holes from the front on the 3010, and 3020 side frame. Leave the 5/8" diameter bolts loose until the entire dozer is mounted on the tractor, and then tighten all bolts securely.

III. Attaching Radiator Guard Mount: (Fig. 4 No. 5)

Remove the weights and weight support bracket from the front of the tractor. Remove the three upper forward bolts from each side of the tractor's side frame. Bolt the Radiator Guard Mount to the tractor using three 5/8" diameter bolts on each side of the tractor and two 3/4" diameter bolts on the front of the tractor.

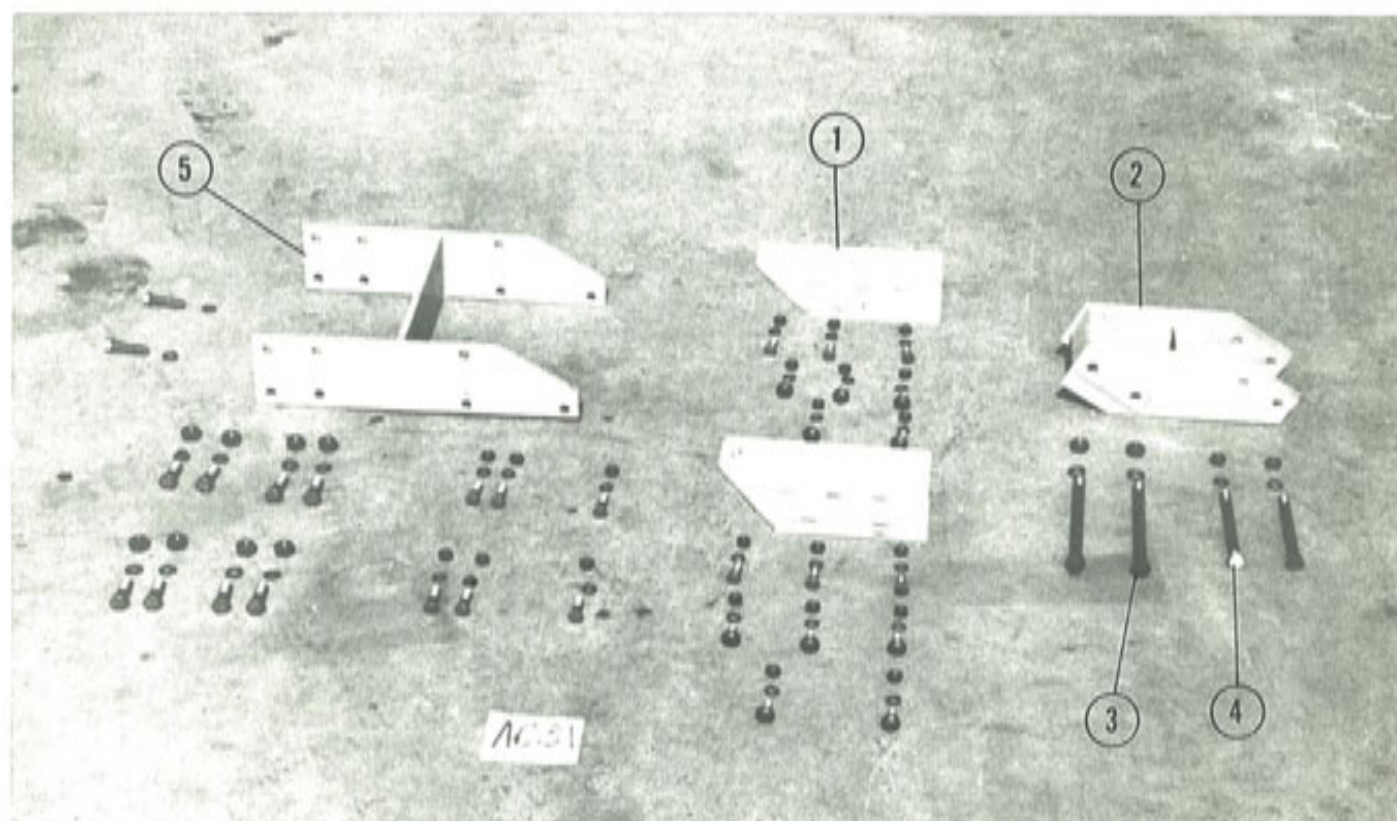

(FIG. 5)

MODEL AC-31 - ADAPTING KIT - ALLIS CHALMERS 190 AND XT190

PARTS LIST

Ref. No.	Description	Part No.	No. Req.
1	Front Mount Plate	5797	2
	Machine Bolt 5/8 x 2 NC (P & HT)	10663	6
	Lock Washer 5/8 (Plated)	11002	16
	Hex Nut 5/8 NC (P & HT)	10668	16
2	Rear Mount Bracket	1601	1
3	Machine Bolt (Fab.)	1594	2
	Lock Washer 7/8 (Plated)	10391	2
	Hex Nut 7/8 NC (Plated)	10436	2
4	Machine Bolt (Fab.)	1602	2
	Lock Washer 3/4 (Plated)	10061	2
	Hex Nut 3/4 NC (Plated) HT	10669	2
	Carriage Bolt 5/8 x 2 NC (P & HT)	10665	10
5	Radiator Guard Mount	1787	1
	Cap Screw 3/4 x 2 NC (P & HT)	10670	10
	Lock Washer 3/4 (Plated)	10061	10

INSTRUCTIONS FOR ATTACHING AMCO FARM TRACTOR DOZER MOUNTING KIT NO. AC-31 TO ALLIS CHALMERS 190 AND XT190 TRACTORS

- I. **Attaching Rear Mount Bracket:** (Fig. 5 No. 2)
The rear mount bracket is designed to mount over the front drawbar mount bracket located under and slightly forward of the rear tractor axle. To mount the bracket, remove the two bolts presently on the tractor and slip the rear end of the bracket over the front drawbar mount. After aligning the bracket's holes with the drawbar mount holes, insert the two 3/4" diameter bolts furnished with the mounting kit (Fig. 5 No. 4). Leave bolts loose until the entire dozer has been mounted on the tractor, then tighten all bolts securely.
- II. **Attaching Front Mount Plates:** (Fig. 5 No. 1)
The two front mount plates mount on each side of the tractor near the motor. The two plates are designed to mount with the three round holes on top and the straight end to the rear. Mount each plate using the three holes near the rear of the tractor's side frame. Leave the 5/8" diameter bolts loose until the entire dozer is mounted on the tractor and then tighten all bolts securely.
- III. **Attaching Radiator Guard Mount:** (Fig. 5 No. 5)
Remove the weights and weight support bracket from the front of the tractor. Remove the three lower forward bolts from each side of the tractor's side frame. Bolt the radiator guard mount to the tractor using three 3/4" diameter bolts on each side of the tractor and two 3/4" diameter bolts on the front of the tractor.

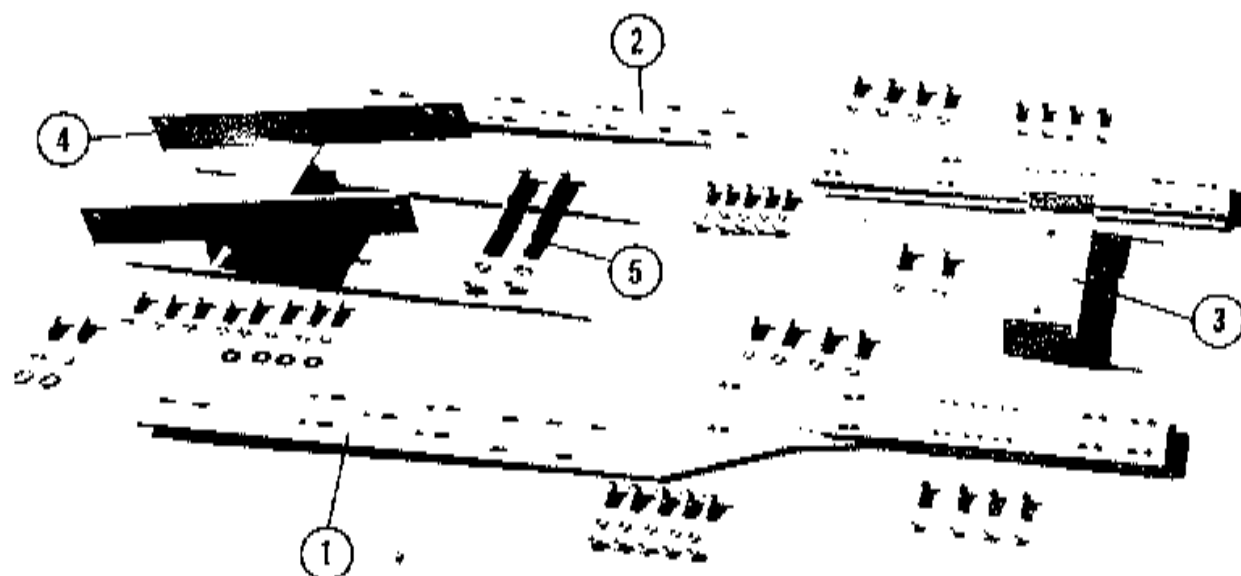

(FIG. 6)

MODEL JC-52 - ADAPTING KIT - JI CASE 930, 1030 ROW CROP

PARTS LIST

Ref. No.	Description	Part No.	No. Req.
1	Front Mount Plate RH	1882	1
2	Mount Plate LH	1883	1
	Machine Bolt 5/8 x 2-1/2 NC HT	10674	4
	Cut Washer 5/8	10059	4
	Lock Washer 5/8 (Plated)	11002	18
	Machine Bolt 1/2 x 2 NC HT	10670	4
	Machine Bolt 1/2 x 2 1/2 NC HT	10678	8
	Cut Washer 1/2	10078	10
3	Front Cross Bar	1884	1
	Lock Washer 1/2 (Plated)	10061	4
	Cap Screw 3/8 x 2 1/4 SAE (Plated)	10704	8
	Lock Nut 1/2 SAE (Plated)	10498	8
4	Rear Mount Bracket	1593	1
5	Machine Bolt 7/8"	1594	2
	Machine Bolt 5/8 x 2 NC HT	10663	4
	Lock Washer 7/8 (Plated)	10391	2
	Hex Nut 7/8 (Plated) NC	10436	2
	Carriage Bolt 5/8 x 2 NC HT	10665	10
	Hex Nut 5/8 NC HT (Plated)	10668	10

INSTRUCTIONS FOR MOUNTING AMCO FARM TRACTOR DOZER MOUNTING KIT NO. JC-52 TO CASE 930 AND 1030 ROW CROP TRACTORS

I. Attaching Rear Mount Bracket: (Fig. 6 No. 4)

The rear mount bracket attaches under and slightly to the rear of the tractor's transmission. Lay the bracket under the tractor with the two side bars facing forward and upward. Lift the front of the bracket and mount the bracket on the side of the transmission housing with one 5/8" diameter bolt. Mount the front of the bracket on the opposite side of the tractor with another 5/8" diameter bolt. Leave both bolts hand tight.

Swing the rear of the bracket up and mount with two 1/2" diameter bolts.

Complete the mounting of the bracket by putting two additional 5/8" diameter bolts in the front of the bracket. Leave the bolts loose until the entire dozer has been mounted, then tighten all bolts securely.

II. Attaching Front Mount Plates: (Fig. 6 No. 1 & 2)

The two front mount plates mount on each side of the engine. The steps on each side of the operator's platform and front end weights must be removed. The small mounting pads should be turned to the rear and inside. Use the front set of mounting holes for the Case 1030 tractor and rear set of mounting holes for the Case 930 tractor.

These plates have two sets of holes for mounting dozer frame carriages. Use the front set of holes for your model 805 farm tractor dozer.

III. Attaching Front Cross Bar: (Fig. 6 No. 3)

Mount the front cross bar to the front of the tractor with two 1/2" diameter bolts. Mount the ends of the cross bar to the side plates using the 1/2" diameter bolts supplied with the dozer kit. The front set of holes should be used for the Case 1030 tractor, and the rear set of holes for the Case 930 tractor.

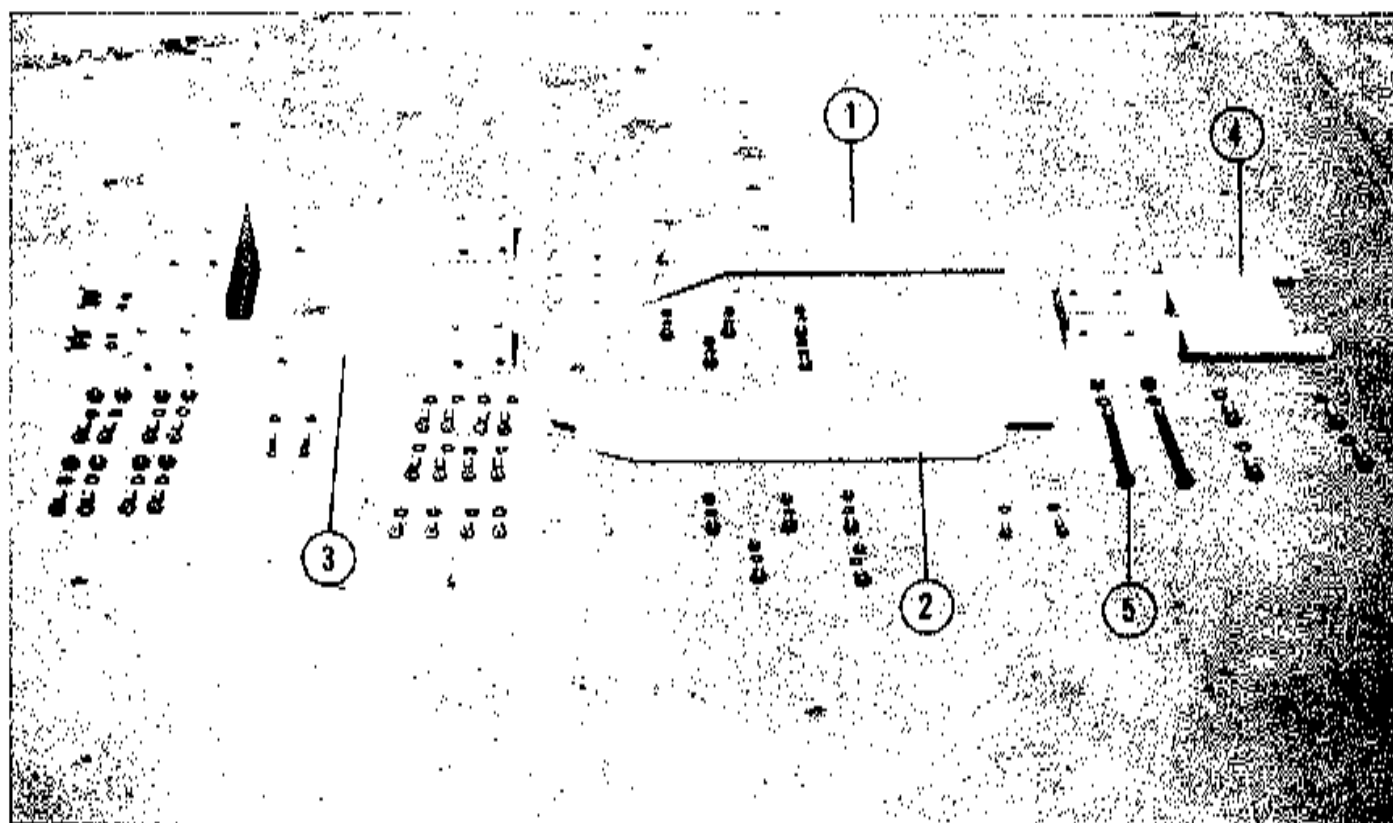

(FIG. 7)

MODEL MF-72 - ADAPTING KIT - MASSEY FERGUSON 1100 AND 1130

PARTS LIST

Ref. No.	Description	Part No.	No. Req.
1	Front Mount Plate RH	1789	1
2	Front Mount Plate LH	1790	1
	Cap Screw $\frac{1}{2}$ x 3 NC (P & HT)	10727	10
	Cap Screw $\frac{1}{2}$ x 2 NC (P & HT)	10670	8
	Lock Washer $\frac{1}{2}$ (Plated)	10061	18
	Cap Screw $\frac{1}{2}$ x 3 NC (P & HT)	10728	2
	Carriage Bolt $\frac{5}{8}$ x 2 NC (P & HT)	10665	10
	Lock Washer $\frac{5}{8}$ (Plated)	11002	10
	Hex Nut $\frac{5}{8}$ NC (P & HT)	10668	10
3	Radiator Guard Mount	1791	1
4	Rear Mount Bracket	1600	1
	Cap Screw 1×5 NC (HT)	10672	4
	Lock Washer 1	11027	4
5	Machine Bolt (Fab.) $\frac{7}{8}$ "	1594	2
	Lock Washer $\frac{7}{8}$ (Plated)	10391	2
	Hex Nut $\frac{7}{8}$ NC (Plated)	10436	2

INSTRUCTIONS FOR ATTACHING AMCO FARM TRACTOR DOZER MOUNTING KIT NO. MF-72 TO MASSEY-FERGUSON 1100 AND 1130 TRACTORS

I. Attaching Rear Mount Bracket: (Fig. 7 No. 4)

The rear mount bracket is designed to mount under the center of the tractor's rear axle. The swinging drawbar cradle should be turned to the rear and attached to the lower lift arms. The rear mount bracket is designed to mount with the flat side of

the plate against the bottom of the tractor and the mounting bars toward the front of the tractor.

Remove the four 1" diameter bolts from the center of the drawbar mounting brackets. These brackets are located under the center of the tractor's rear axle. Lift the rear mount bracket and align the holes in the mount bracket with those on the tractor. Secure the bracket with the four 1" diameter bolts supplied with the dozer mounting kit. Tighten all four bolts hand tight, but do not tighten completely until after the entire dozer has been mounted on the tractor.

II. Attaching Front Mount Plates: (Fig. 7 No. 1 & 2)

The front mount plates mount on each side of the tractor's engine. Bolt the two front mount plates onto the tractor with the ribs turned toward the inside. Do not insert the upper forward four bolts until after the front mount cradle has been installed. Leave the bolts loose until the entire dozer has been mounted on the tractor then tighten all bolts securely.

III. Attaching Radiator Guard Mount: (Fig. 7 No. 3)

Remove the weights and weight support bracket from the front of the tractor. Remove the $\frac{1}{3}$ " diameter bolts located on each side of the tractor near the lower front part of the tractor's hood.

Bolt the Radiator Guard Mount to the tractor using one $\frac{1}{2}$ " diameter bolt and four $\frac{1}{4}$ " diameter bolts on each side of the tractor and two $\frac{3}{4}$ " diameter on the front of the tractor.

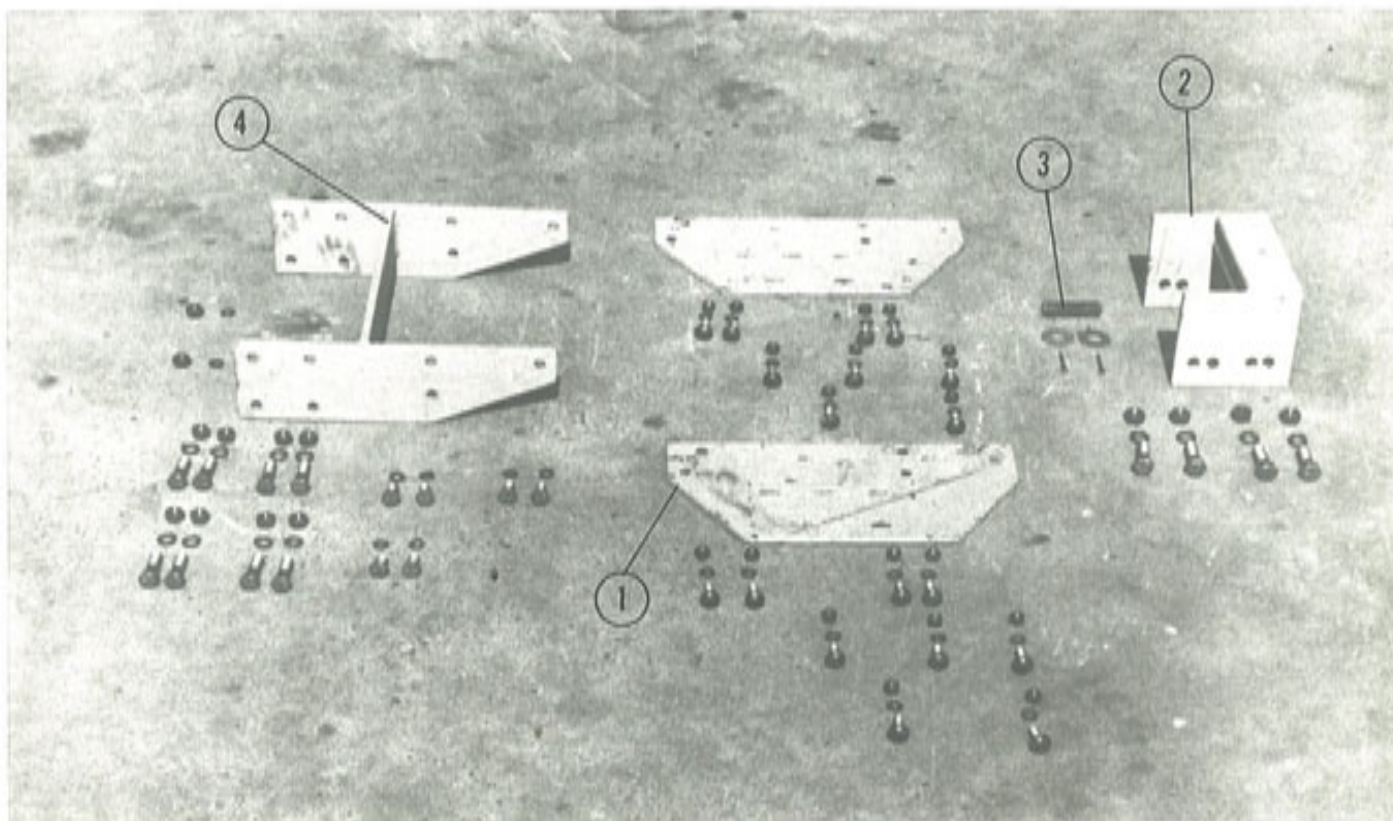

(FIG. 8)

MODEL MM-81 - ADAPTING KIT - MINNEAPOLIS MOLINE 670 AND SUPER TRACTORS

PARTS LIST

Ref. No.	Description	Part No.	No. Req.
1	Front Mount Plate	6928	2
	Carriage Bolt 5/8 x 2 NC (P & HT)	10065	12
	Lock Washer 5/8 (Plated)	11002	12
	Hex Nut 5/8 NC (P & HT)	10668	12
	Cap Screw 3/4 x 2 1/2 NC (P & HT)	10678	4
	Cap Screw 3/4 x 2 NC (P & HT)	10670	6
	Lock Washer 3/4 (Plated)	10061	10
	Hex Nut 3/4 NC (P & HT)	10669	10
2	Rear Mount Bracket	1639	1
	Machine Bolt 7/8 x 3 NC	10189	4
	Lock Washer 7/8	10035	4
	Hex Nut 7/8 NC	10148	4
3	Retainer Pin	6929	1
	Cotter Pin 1/4 x 1 1/2	10075	2
	Cut Washer 1"	10090	2
4	Radiator Guard Mount	1788	1

INSTRUCTIONS FOR ATTACHING AMCO FARM TRACTOR DOZER MOUNTING KIT NO. MM-81 TO MINNEAPOLIS MOLINE 670 SUPER TRACTORS

I. Attaching Rear Mount Bracket: (Fig. 8 No. 2)

The Rear Mount bracket is designed to mount on the front end of the tractor's swinging drawbar.

Remove the pull pin that holds the swinging drawbar in place, and slide the drawbar as far forward as possible. After sliding the drawbar forward, replace the pull pin and fasten the drawbar at the rear of the tractor to keep it from swinging. Slide the rear mount bracket onto the front of the drawbar. The straight side should be toward the front of the tractor. Insert the retainer pin (Fig. 8 No. 3) through the hole in the bracket and the tractor's drawbar. Secure the connecting pin with cotter pins.

II. Attaching Front Mount Plate: (Fig. 8 No. 1)

The two front mount plates mount on each side of the tractor near the motor. Align the holes on the plates to match the holes on the tractor. Let all bolts stay loose until the complete Dozer Blade has been mounted to the tractor, then tighten all bolts securely.

III. Attaching Radiator Guard Mount: (Fig. 8 No. 4)

Remove the weights and weight support bracket from the front of the tractor.

Remove the three upper forward bolts from each side of the tractor's side frame.

Bolt the Radiator Guard Mount to the tractor using three 3/4" diameter bolts on each side of the tractor and two 3/4" nuts on the front of the tractor.

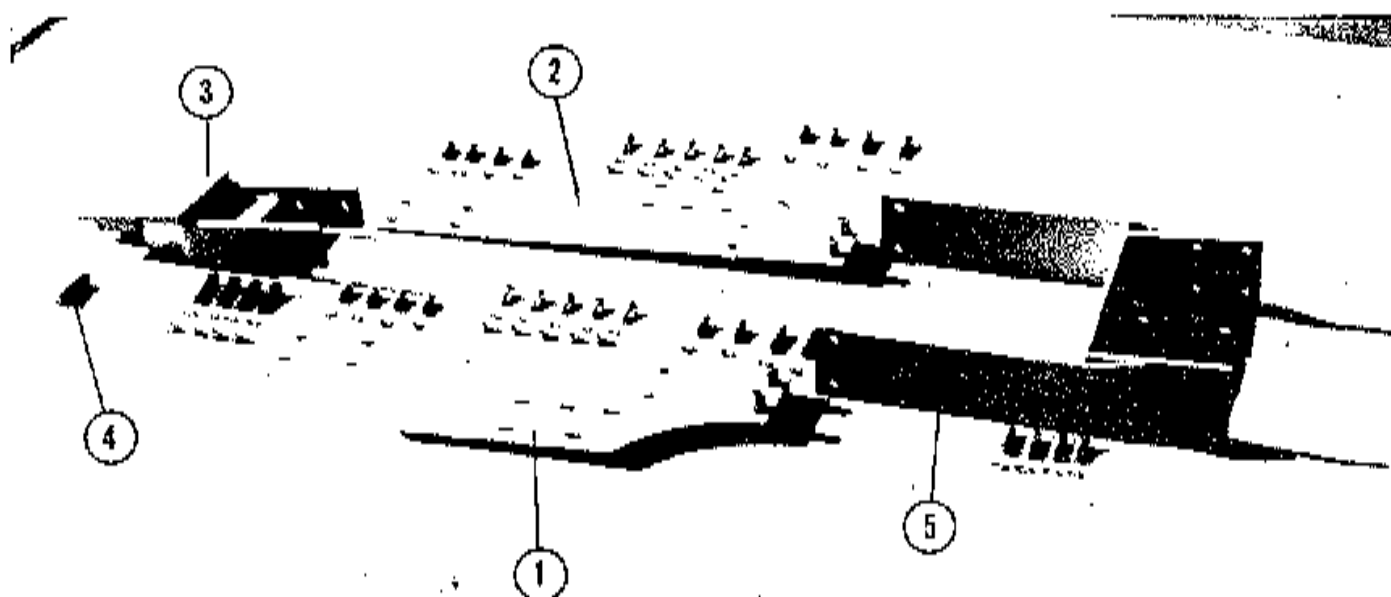

(FIG. 9)

MODEL OC-91 - ADAPTING KIT - OLIVER 1800, 1850 TRACTORS

PARTS LIST

Ref. No.	Description	Part No.	No. Req.
1	Front Mount Plate RH	1903	1
2	Front Mount Plate LH	1904	1
	Cap Screw $\frac{1}{4}$ x $2\frac{1}{2}$ NC HT	10678	4
	Cap Screw $\frac{1}{4}$ x $1\frac{1}{2}$ NC HT	10679	12
	Cap Screw $\frac{1}{4}$ x $5\frac{1}{2}$ NC	10323	4
	Flat Washer $\frac{3}{4}$	10078	8
	Lock Washer $\frac{1}{2}$ (Plated)	10061	20
	Carriage Bolt $\frac{5}{8}$ x 2 NC HT	10065	10
	Lock Washer $\frac{5}{8}$ (Plated)	11002	10
	Hex Nut $\frac{5}{8}$ NC HT (Plated)	10668	10
3	Rear Mount Bracket	1646	1
	Machine Bolt $\frac{7}{8}$ x 3 NC	10189	4
	Lock Washer $\frac{7}{8}$	10035	4
	Hex Nut $\frac{7}{8}$ NC	10148	4
4	Retainer Pin	7332	1
	Cotter Pin $\frac{1}{4}$ x 2	10087	1
5	Radiator Guard Mount	1905	1

INSTRUCTIONS FOR ATTACHING AMCO FARM TRACTOR DOZER MOUNTING KIT NO. OC-91 TO OLIVER 1800, AND 1850

I. Attaching Front Mount Plate: (Fig. 9 No. 1 & 2)

The front mount plate consists of a right hand and a left hand. The mount plates have spacer blocks welded to them. Place these to the front of the tractor with the flat spacer blocks against the tractor. The two $\frac{1}{4}$ " x $2\frac{1}{2}$ " machine bolts are used to mount the front of the plates. The four $\frac{1}{4}$ " x $1\frac{1}{2}$ " machine bolts are used to mount the rear of the plates to the tractor. Align the holes on the plates to the holes on the tractor frame. Let all bolts stay loose until the complete blade has been attached to the tractor, and then tighten all bolts securely.

II. Attaching Rear Mount Bracket: (Fig. 9 No. 3)

Remove the tractor's drawbar and drawbar mounting bracket. Replace the tractor's drawbar mounting bracket with the dozer rear mount bracket. Attach the tractor's drawbar to the dozer rear mount bracket with the $\frac{7}{8}$ " diameter pin furnished with the dozer mounting kit.

III. Attaching Radiator Guard Mount: (Fig. 9 No. 5)

Remove the weights from the front of the tractor. Mount the radiator guard mount to the tractor using four $\frac{1}{4}$ " x $5\frac{1}{2}$ " and four $\frac{1}{4}$ " x $1\frac{1}{2}$ " machine bolts.

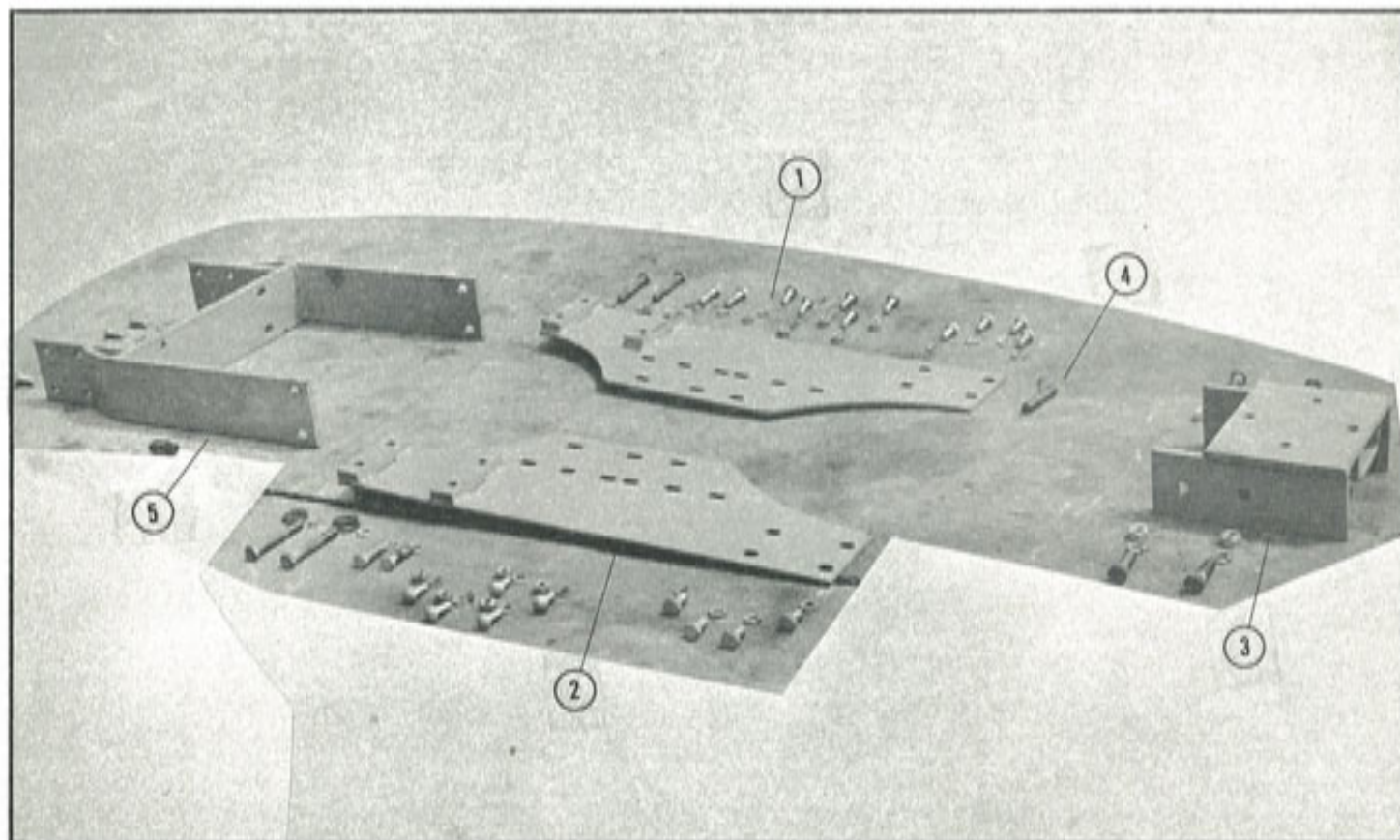

(FIG. 10)

MODEL OC-94 – ADAPTING KIT – OLIVER 1850 TRACTORS W/87" WHEEL BASE

PARTS LIST

Ref. No.	Description	Part No.	No. Req.
1	Front Mount Plate RH	1903	1
2	Front Mount Plate LH	1904	1
	Cap Screw $\frac{3}{4}$ x $2\frac{1}{2}$ NC HT	10678	4
	Cap Screw $\frac{3}{4}$ x $1\frac{1}{2}$ NC HT	10679	12
	Cap Screw $\frac{3}{4}$ x $5\frac{1}{2}$ NC	10323	4
	Cut Washer $\frac{3}{4}$	10078	8
	Lock Washer $\frac{3}{4}$ (Plated)	10061	20
	Carriage Bolt $\frac{5}{8}$ x 2 NC HT	10665	10
	Lock Washer $\frac{5}{8}$ (Plated)	11002	10
	Hex Nut $\frac{5}{8}$ NC HT (Plated)	10668	10
3	Rear Mount Bracket	1995	1
	Machine Bolt $\frac{7}{8}$ x 3 NC	10189	4
	Lock Washer $\frac{7}{8}$	10035	4
	Hex Nut $\frac{7}{8}$ NC	10148	4
4	Retainer Pin	7332	1
	Cotter Pin $\frac{1}{4}$ x 2	10087	1
5	Radiator Guard Mount	1905	1

**INSTRUCTIONS FOR ATTACHING AMCO FARM
TRACTOR DOZER MOUNTING KIT NO. OC-94 TO
OLIVER 1850 W/87" WHEEL BASE**

- I. **Attaching Front Mount Plate:** (Fig. 10, No. 1 & 2)
The front mount plate consists of a right hand and a left hand. The mount plates have spacer blocks welded to them. Place these to the front of the tractor with the flat spacer blocks against the tractor. The two $\frac{3}{4}$ " x $2\frac{1}{2}$ " machine bolts are used to mount the front of the plates. The four $\frac{3}{4}$ " x $1\frac{1}{2}$ " machine bolts are used to mount the rear of the plates to the tractor. Align the holes on the plates to the holes on the tractor frame. Let all bolts stay loose until the complete blade has been attached to the tractor, and then tighten all bolts securely.
- II. **Attaching Rear Mount Bracket:** (Fig. 10, No. 3)
Remove the tractor's drawbar and drawbar mounting bracket. Replace the tractor's drawbar mounting bracket with the dozer rear mount bracket. Attach the tractor's drawbar to the dozer rear mount bracket with the $\frac{7}{8}$ " diameter pin furnished with the dozer mounting kit.
- III. **Attaching Radiator Guard Mount:** (Fig. 10, No. 5)
Remove the weights from the front of the tractor. Mount the radiator guard mount to the tractor using four $\frac{3}{4}$ " x $5\frac{1}{2}$ " and four $\frac{3}{4}$ " x $1\frac{1}{2}$ " machine bolts.



**Operating and
Assembly Instructions
AMCO Dozer Blade
MODEL NO. 805 Straight, Tilt and Angle**

EFFECTIVE DATE

NOVEMBER 1, 1967

Alexander Manufacturing Company
*Manufacturers of Quality-Built Farm and
Industrial Equipment*

YAZOO CITY, MISSISSIPPI, USA

P. O. Box 107

Phone 746-4464