

TYPE — WOF10  
Rigid Frame  
Wheel Type Offset

# PARTS LIST Rigid Frame Wheel

WOF10

Ref. No.	Description	Model 2422	WOF10 2424	Model 2622	WOF10 2624	Model 2822	WOF10 2824	Model 3022	WOF10 3024	Model 3222	WOF10 3224	Model 3622	WOF10 3624
		Part No.	No. Req.	Part No.	No. Req.	Part No.	No. Req.	Part No.	No. Req.	Part No.	No. Req.	Part No.	No. Req.
1	Hitch Swivel	1459	1	1459	1	1459	1	1459	1	1459	1	1459	1
2	Collar	6423	1	6423	1	6423	1	6423	1	6423	1	6423	1
	Cap Screw — Hex Hd. — 3/4" x 4" USS	10104	1	10104	1	10104	1	10104	1	10104	1	10104	1
	Lock Washer — 3/4"	10002	1	10002	1	10002	1	10002	1	10002	1	10002	1
	Nut — Hex — 3/4" USS	10143	1	10143	1	10143	1	10143	1	10143	1	10143	1
3	Pull Tongue	1476	1	1476	1	1476	1	1476	1	1476	1	1476	1
4	Adj. Plate	6645	2	6645	2	6645	2	6645	2	6645	2	6645	2
	Machine Bolt — Sq. Hd. — 3/4" x 5 1/2" USS	10323	2	10323	2	10323	2	10323	2	10323	2	10323	2
	Lock Washer — 3/4"	10002	2	10002	2	10002	2	10002	2	10002	2	10002	2
	Nut Hex — 3/4" USS	10143	2	10143	2	10143	2	10143	2	10143	2	10143	2
	Machine Bolt — Hex Hd. — 1" x 6" USS	10181	4	10181	4	10181	4	10181	4	10181	4	10181	4
	Lock Washer — 1"	11027	4	11027	4	11027	4	11027	4	11027	4	11027	4
	Nut Hex — 1" USS	11026	4	11026	4	11026	4	11026	4	11026	4	11026	4
5	Cross Tongue	1553	1	1553	1	1553	1	1553	1	1553	1	1553	1
	Cap Screw — Hex Hd. — 1" x 4" USS	10094	2	10094	2	10094	2	10094	2	10094	2	10094	2
	Lock Washer — 1"	11027	2	11027	2	11027	2	11027	2	11027	2	11027	2
	Nut Hex — 1" USS	11026	2	11026	2	11026	2	11026	2	11026	2	11026	2
6	Hose Holder	771	1	771	1	771	1	771	1	771	1	771	1
	Cotter Pin — 1/4" x 1 1/2"	10075	1	10075	1	10075	1	10075	1	10075	1	10075	1
7	Stabilizer Rod	3008	1	3008	1	3008	1	3008	1	3008	1	3008	1
	Cotter Pin — 1/4" x 1 1/2"	10075	1	10075	1	10075	1	10075	1	10075	1	10075	1
	Machine Bolt — Hex Hd. — 5/8" x 3 3/4"	10241	1	10241	1	10241	1	10241	1	10241	1	10241	1
	Lock Washer — 5/8"	10010	1	10010	1	10010	1	10010	1	10010	1	10010	1
	Nut — Hex — 5/8" USS	11029	1	11029	1	11029	1	11029	1	11029	1	11029	1
8	Stabilizer Spring—2"—I.D. x 3"—O.D.—6" Long	10308	1	10308	1	10308	1	10308	1	10308	1	10308	1
9	Spring Guide Sleeve	773	1	773	1	773	1	773	1	773	1	773	1
10	Trunnion Stabilizer	774	1	774	1	774	1	774	1	774	1	774	1
	Machine Bolt — Hex Hd. — 5/8" x 1 1/2" (Plated)	10188	2	10188	2	10188	2	10188	2	10188	2	10188	2
	Lock Washer — 5/8" (Plated)	11002	2	11002	2	11002	2	11002	2	11002	2	11002	2
	Nut Hex — 5/8" USS (Plated)	10139	2	10139	2	10139	2	10139	2	10139	2	10139	2
	Stop Stabilizer	775	1	775	1	775	1	775	1	775	1	775	1
11	Nut Adj. Stabilizer	776	1	776	1	776	1	776	1	776	1	776	1
12	Stabilizer Control	873	1	873	1	873	1	873	1	873	1	873	1
	Stabilizer Control Pin	874	1	874	1	874	1	874	1	874	1	874	1
	Cotter Pin — 1/4" x 2"	10087	1	10087	1	10087	1	10087	1	10087	1	10087	1
13	Turn Buckle Stud — RH	875	1	875	1	875	1	875	1	875	1	875	1
14	Turn Buckle Stud — LH	876	1	876	1	876	1	876	1	876	1	876	1
	Turn Buckle Housing	877	1	877	1	877	1	877	1	877	1	877	1
	Turn Buckle Pin	878	2	878	2	878	2	878	2	878	2	878	2
	Cotter Pin — 1/4" x 2"	10087	4	10087	4	10087	4	10087	4	10087	4	10087	4
15	Main Frame	944	1	944	1	1240	1	1240	1	1240	1	1472	1
16	Leveling Arm	872	1	872	1	872	1	872	1	872	1	872	1
	Rivet — 1" x 3"	10099	1	10099	1	10099	1	10099	1	10099	1	10099	1
	Cotter Pin — 1/4" x 2"	10087	2	10087	2	10087	2	10087	2	10087	2	10087	2
17	Front Gang Frame	870	1	1102	1	869	1	1107	1	1109	1	1473	1
	Scraper Standard — RH	945	10	945	11	945	12	945	13	945	14	945	15
	Scraper End Special — RH	946	1	946	1	946	1	946	1	946	1	946	1
18	Rear Gang Frame	779	1	1103	1	781	1	1108	1	1110	1	1474	1
	Scraper Standard — LH	947	10	947	11	947	12	947	13	947	14	947	15
	Scraper End Special — LH	948	1	948	1	948	1	948	1	948	1	948	1
	Carriage Bolt W/Nut — 7/16" x 1 1/2" USS	10068	44	10068	48	10068	52	10068	56	10068	60	10068	64
	Lock Washer — 7/16"	10619	44	10619	48	10619	52	10619	56	10619	60	10619	64
19	Gang Pivot Bolt	11021	2	11021	2	11021	2	11021	2	11021	2	11021	2
	Cut Washer — 1 1/4"	10077	4	10077	4	10077	4	10077	4	10077	4	10077	4
	Nut — Hex (Slotted) 1 1/4"	10076	2	10076	2	10076	2	10076	2	10076	2	10076	2
	Cotter Pin — 1/4" x 3"	10617	2	10617	2	10617	2	10617	2	10617	2	10617	2
20	"J" Bolt	2542	4	2542	4	2542	8	2542	8	2542	8	2542	8
	Carriage Bolt — 1" x 2 1/2" USS	10318	4	10318	4	10318	8	10318	8	10318	8	10318	8
	Lock Washer — 1"	11027	8	11027	8	11027	16	11027	16	11027	16	11027	16
	Nut — Hex — 1" USS	11026	8	11026	8	11026	16	11026	16	11026	16	11026	16
21	Rockshaft	949	1	949	1	949	1	949	1	949	1	949	1

(Continued Next Page)

Re No.	Description	Model 2422	WOF10 2424	Model 2622	WOF10 2624	Model 2822	WOF10 2824	Model 3022	WOF10 3024	Model 3222	WOF10 3224	Model 3622	WOF10 3624	
		Part No.	No. Req.	Part No.	No. Req.	Part No.	No. Req.	Part No.	No. Req.	Part No.	No. Req.	Part No.	No. Req.	
22	Base Rockshaft Brg.	3426	2	3426	2	3426	2	3426	2	3426	2	3426	2	
23	Cap Rockshaft Brg.	3425	2	3425	2	3425	2	3425	2	3425	2	3425	2	
	Machine Bolt — 7/8" x 7" USS	10431	4	10431	4	10431	4	10431	4	10431	4	10431	4	
	Lock Washer — 7/8"	10035	4	10035	4	10035	4	10035	4	10035	4	10035	4	
	Nut — Hex — 7/8" USS	10148	4	10148	4	10148	4	10148	4	10148	4	10148	4	
	Wheel Support	1475	4	1475	4	1475	4	1475	4	1475	4	1475	4	
	Machine Bolt — 1" x 3" USS	11025	8	11025	8	11025	8	11025	8	11025	8	11025	8	
	Lock Washer — 1"	11027	8	11027	8	11027	8	11027	8	11027	8	11027	8	
	Nut — Hex — 1" USS	11026	8	11026	8	11026	8	11026	8	11026	8	11026	8	
24	Transport Bar	1443	1	1443	1	1443	1	1443	1	1443	1	1443	1	
	Rivet (Drilled) 3/4" x 2 1/2"	10019	1	10019	1	10019	1	10019	1	10019	1	10019	1	
	Rivet (Drilled) 3/4" x 3"	10052	1	10052	1	10052	1	10052	1	10052	1	10052	1	
	Cotter Pin — 1/4" x 1 1/2"	10075	2	10075	2	10075	2	10075	2	10075	2	10075	2	
25	Bearing Housing — Front Half	6405	8	6405	8	6405	8	6405	8	6405	8	6405	12	
26	Bearing Housing — Rear Half	6406	8	6406	8	6406	8	6406	8	6406	8	6406	12	
	Carriage Bolt — 3/4" x 3"	10579	16	10579	16	10579	16	10579	16	10579	16	10579	24	
	Lock Washer — 3/4"	10002	16	10002	16	10002	16	10002	16	10002	16	10002	24	
	Nut — Hex — 3/4" SAE	10585	16	10585	16	10585	16	10585	16	10585	16	10585	24	
27	Hub W/2 Cups & 5 Lug Bolts	10581	4	10581	4	10581	4	10581	4	10581	4	10581	4	
28	Cup Inner (Timken — LM 48510)	10352	4	10352	4	10352	4	10352	4	10352	4	10352	4	
29	Cone Inner (Timken — LM 48548)	10353	4	10353	4	10353	4	10353	4	10353	4	10353	4	
30	Grease Seal — AFS 2130	10582	4	10582	4	10582	4	10582	4	10582	4	10582	4	
31	Hub Bolt	10354	20	10354	20	10354	20	10354	20	10354	20	10354	20	
32	Nut — Hub (FS 8320)	11046	20	11046	20	11046	20	11046	20	11046	20	11046	20	
33	Cup — Outer (LM 67010)	10293	4	10293	4	10293	4	10293	4	10293	4	10293	4	
34	Cone — Outer (LM 67048)	10295	4	10295	4	10295	4	10295	4	10295	4	10295	4	
35	Spindle Washer	10263	4	10263	4	10263	4	10263	4	10263	4	10263	4	
36	Spindle Nut — 7/8" SAE (Slotted)	10264	4	10264	4	10264	4	10264	4	10264	4	10264	4	
37	Cotter Pin — 3/16" x 1 1/2"	10027	4	10027	4	10027	4	10027	4	10027	4	10027	4	
38	Hub Cap	10356	4	10356	4	10356	4	10356	4	10356	4	10356	4	
39	Grease Fitting — Straight	10606	4	10606	4	10606	4	10606	4	10606	4	10606	4	
40	Gang Bolt	5644	4	5644	2	5623	4	5623	2	5624	4	5644	6	
	Gang Bolt			5623	2			5624	2					
41	Bumper Washer	2386	4	2386	4	2386	4	2386	4	2386	4	2386	6	
42	Blade — 24" Cut Out	3250	24	3250	26	3250	28	3250	30	3250	32	3250	36	
42A	Blade — 16" Back-Up	3055	24	3055	26	3055	28	3055	30	3055	32	3055	36	
43	End Bell — Small	6400	8	6400	8	6400	8	6400	8	6400	8	6400	12	
44	Housing Bearing	G6404	8	G6404	8	G6404	8	G6404	8	G6404	8	G6404	12	
45	Bearing — Anti-Friction (GW214PP2)	G10218	8	G10218	8	G10218	8	G10218	8	G10218	8	G10218	12	
46	Ring Retainer	11072	8	11072	8	11072	8	11072	8	11072	8	11072	12	
47	End Bell Large	6401	8	6401	8	6401	8	6401	8	6401	8	6401	12	
48	Spacer Spool (Fabricated)	545	12	545	14	545	16	545	18	545	20	545	18	
	End Gang Washer	1222	4	1222	4	1222	4	1222	4	1222	4	1222	6	
	Lock Plate — Nut	5622	4	5622	4	5622	4	5622	4	5622	4	5622	6	
49	Nut — Gang Bolt	10489	4	10489	4	10489	4	10489	4	10489	4	10489	6	
	Carr. Bolt 7/16" x 1 1/2"	10068	8	10068	8	10068	8	10068	8	10068	8	10068	12	
	Lock Washer — 7/16"	10619	8	10619	8	10619	8	10619	8	10619	8	10619	12	
	Nut — Hex — 7/16"	10618	8	10618	8	10618	8	10618	8	10618	8	10618	12	
	— OPTIONAL PARTS —													
	Wheel — 15 x 5 — KDC — 5-Hole	10025	4	10025	4	10025	4	10025	4	10025	4	10025	4	
	Tire — 6:70 x 15 — 4-Ply — Imp.	11041	4	11041	4	11041	4	11041	4	11041	4	11041	4	
	Tube — 6:70 x 15	11040	4	11040	4	11040	4	11040	4	11040	4	11040	4	
	Wheel — Rim — Inner — 4:00 x 9	11009	4	11009	4	11009	4	11009	4	11009	4	11009	4	
	Wheel — Rim — Outer — 4:00 x 9	11010	4	11010	4	11010	4	11010	4	11010	4	11010	4	
	Tire — 6:00 x 9 — Pneumatic	11011	4	11011	4	11011	4	11011	4	11011	4	11011	4	
	Tire — 6:00 x 9 — Laminated	10302	4	10302	4	10302	4	10302	4	10302	4	10302	4	
	Tube — 6:00 x 9	11012	4	11012	4	11012	4	11012	4	11012	4	11012	4	

## ALEXANDER MANUFACTURING COMPANY

NO. 1 AMCO DRIVE

PHONE (601) 746-4464

YAZOO CITY, MISSISSIPPI 39194

# Wheel Type Offset- WOF10

WOF12

WHEN ORDERING PARTS,  
PLEASE SPECIFY  
TYPE, MODEL, SERIAL NO.

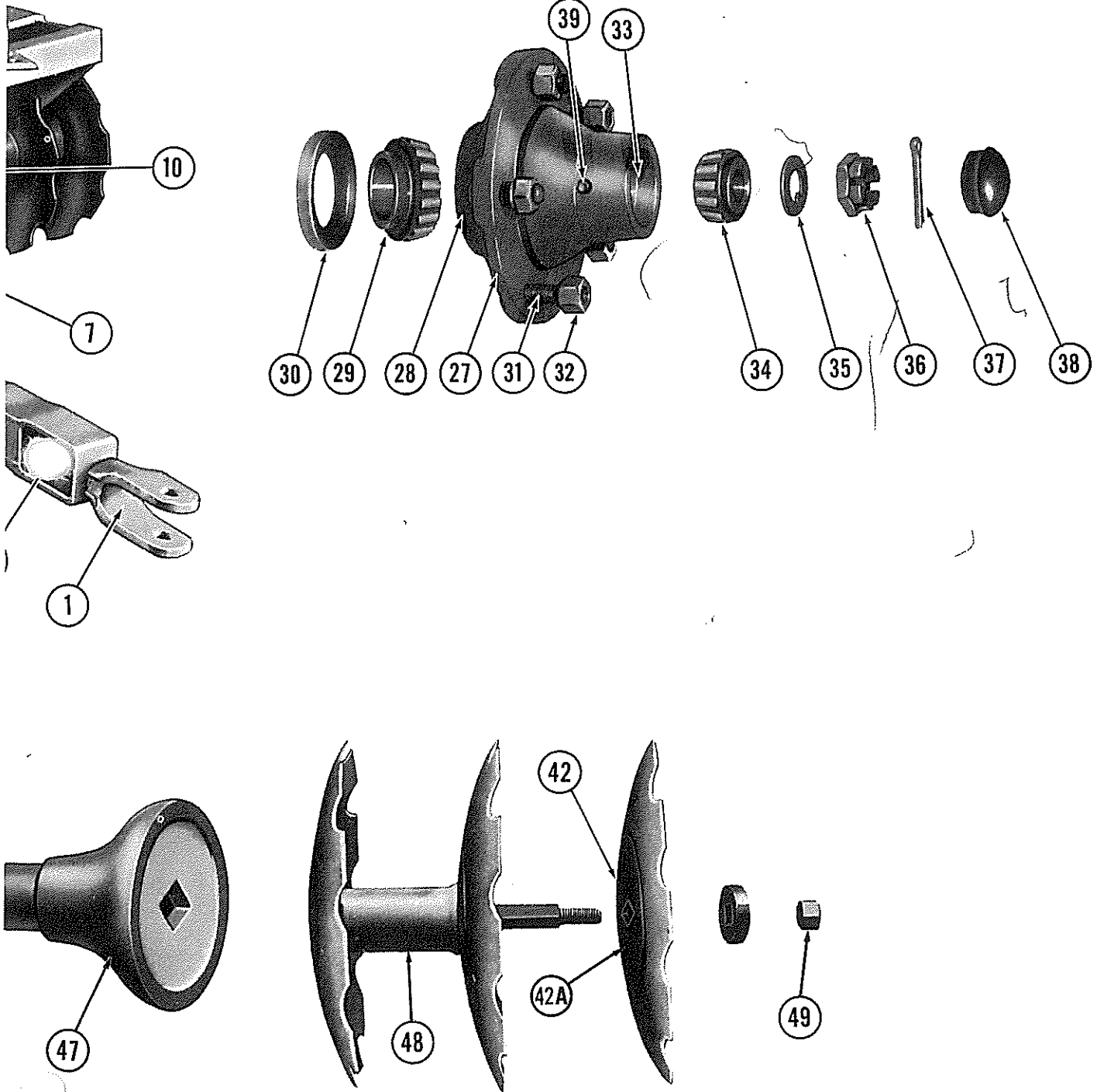

# PARTS LIST



# Rigid Fram

